



# Tangent 3

INSTALLATION GUIDE



HANDMADE  
IN U.S.A.



WEAR GLOVES  
DURING INSTALL

**FRAGILE FINISHES**

**DANGER:** ELECTRIC SHOCK RISK. TURN OFF ELECTRICAL POWER BEFORE BEGINNING INSTALLATION AND USE CAUTION WHEN INSTALLING.



+1 212 334 7333

[www.alliedmaker.com](http://www.alliedmaker.com) • [sales@alliedmaker.com](mailto:sales@alliedmaker.com)



1

—  
Inspect Contents



Hang Rod



2x Machine Screw

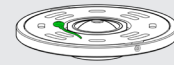

Canopy Assembly



3x Light Bulb

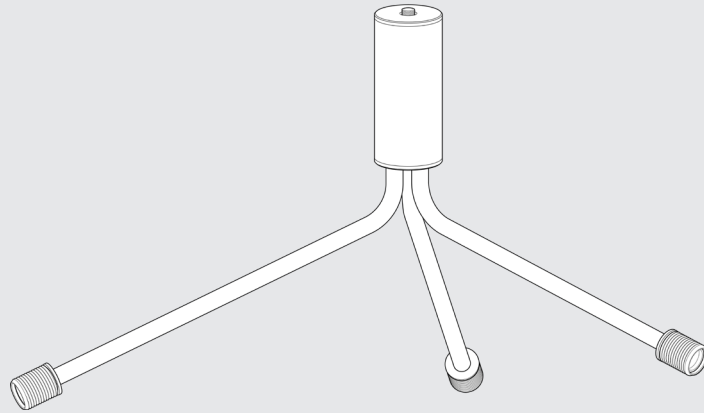

Fixture



Ball Joint

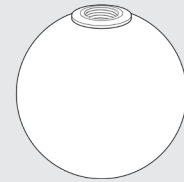

3x Glass



1/16 Hex Screwdriver



Terminology

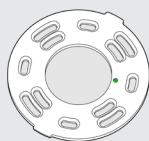

Universal Backplate



Adapter



3x Socket Cover  
&  
3x Fixture Socket



Phillips Screwdriver  
(Not Included)



Canopy  
&  
Set Screw



Lock Ring



Fixture Body

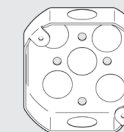

Junction Box  
(Not Included)

3



Preparation

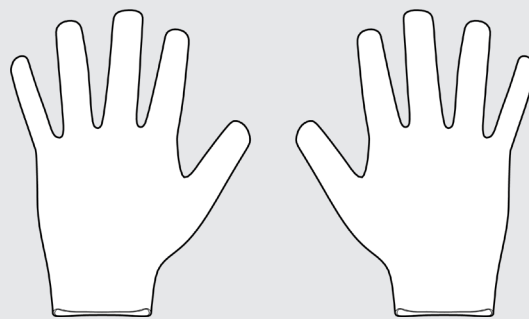

Nitrile Gloves

4

---

Unscrew and remove the  
lock ring from the adapter.

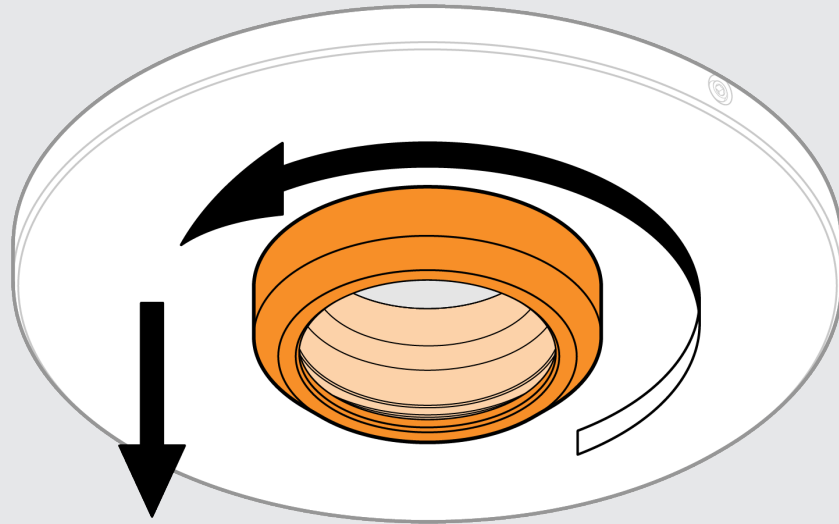

5

---

Using the hex screwdriver, loosen the set screw on the canopy and remove the universal backplate.

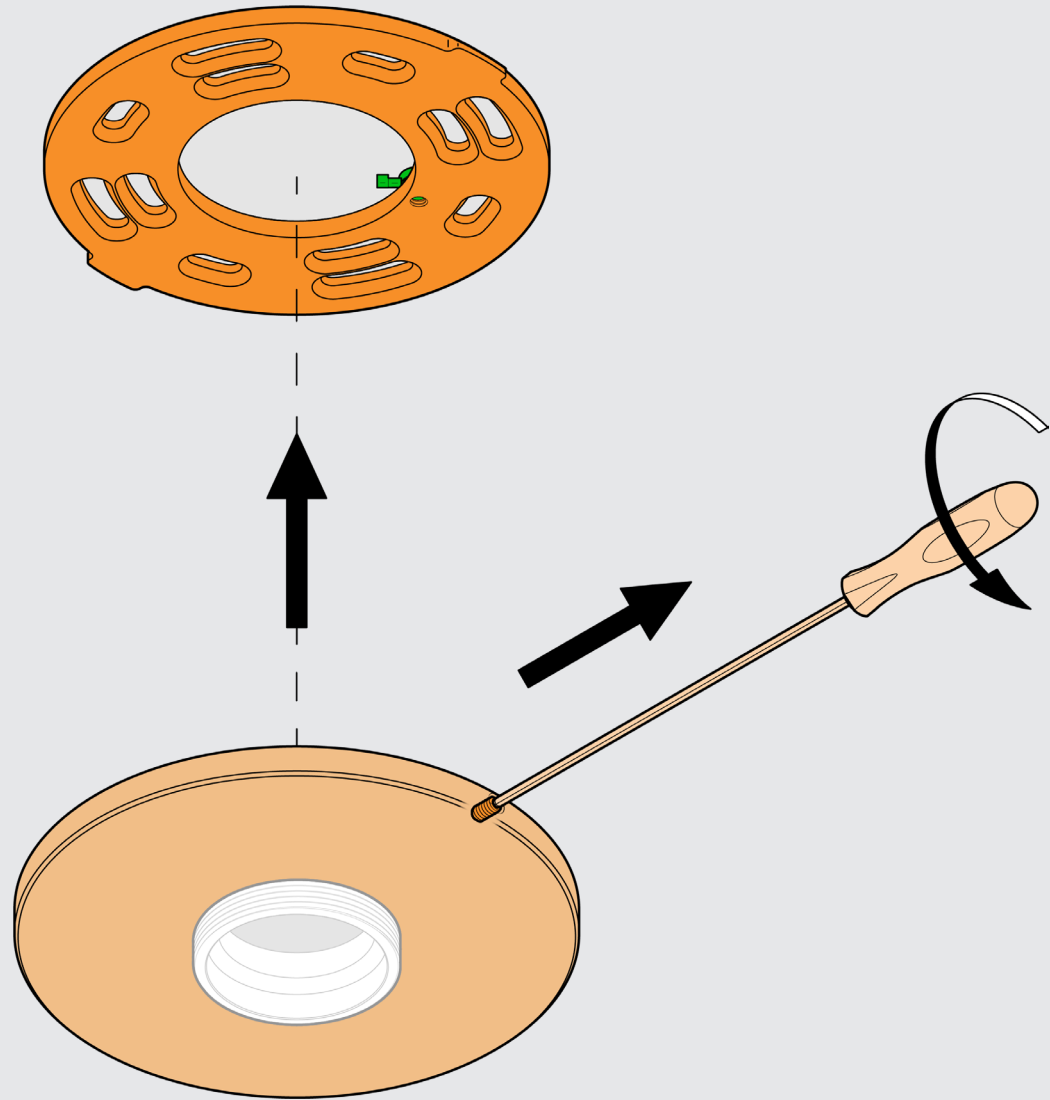

6

Mount the universal backplate onto the junction box using the provided machine screws.

**NOTE:** Make sure the two tabs on the universal backplate are rotated to a minimum of  $10^\circ$  from the intended mounting alignment. This will ensure the set screw has enough space to fully secure the canopy and universal backplate into place.

**CAUTION:** Do not overtighten the machine screws. Overtightening will prevent the two tabs on the universal backplate from engaging with the channel inside the canopy.

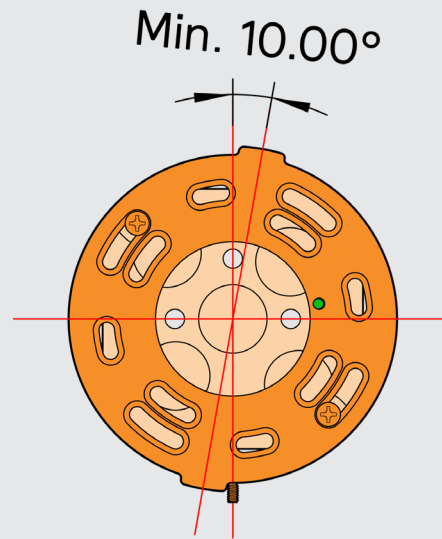

Do Not Overtighten  
Machine Screws

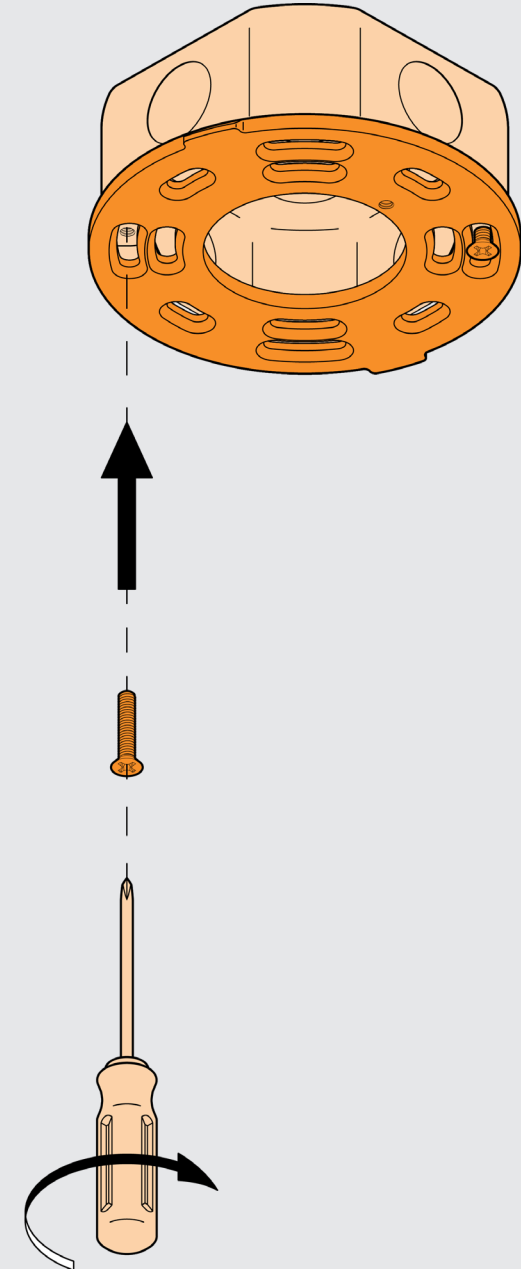
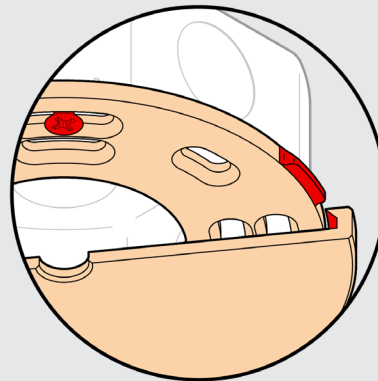

7

---

Connect the ground wire from the universal backplate with the ground wire from the junction box using a wire nut. Then, insert the ground wires into the junction box. Next, travel the wires from the junction box through the centerhole of the canopy. Align the tabs on the universal backplate with the tab openings on the canopy. Then, place the canopy over the universal backplate and rotate the canopy to the desired position.

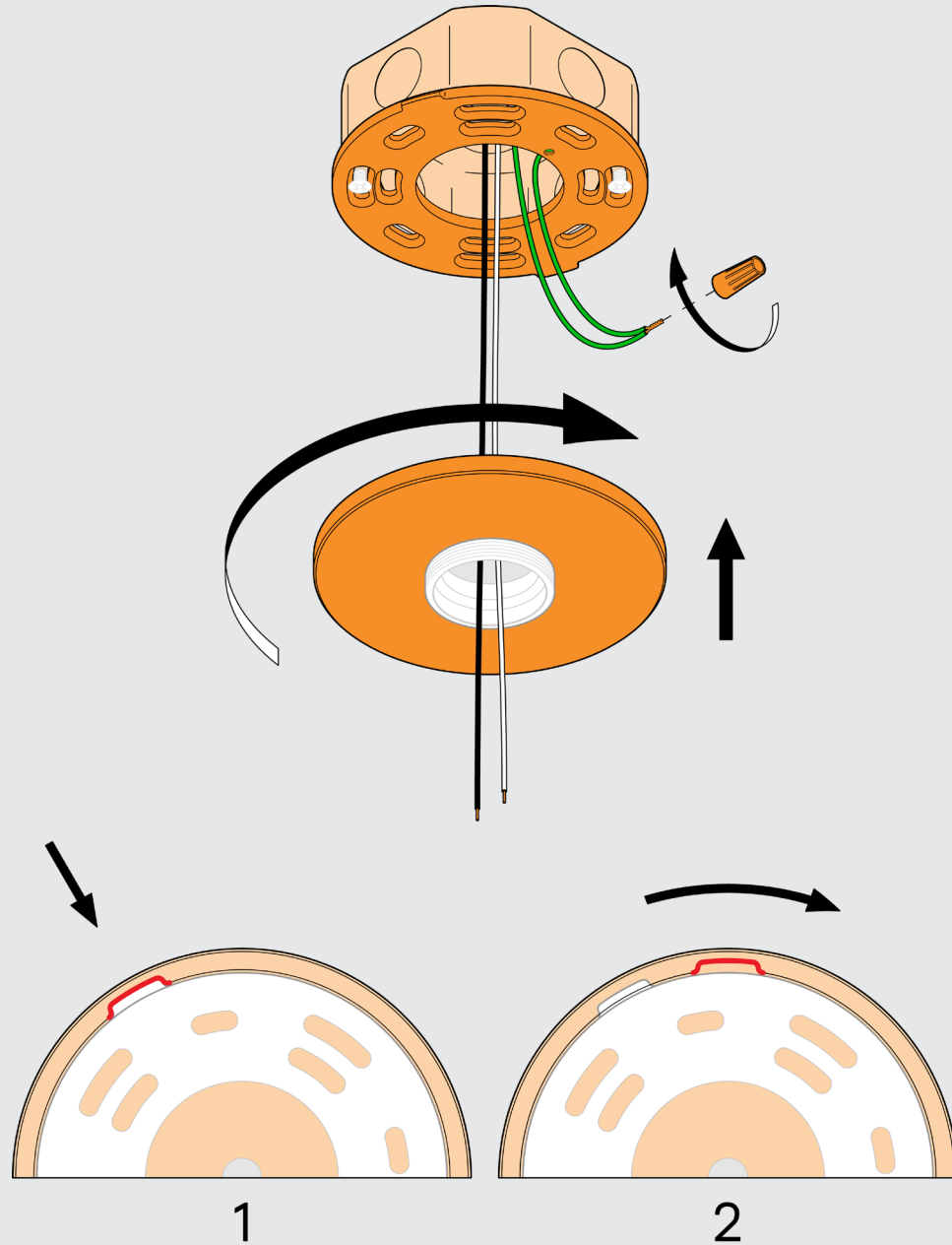

8

---

Using the hex screwdriver, tighten the set screw on the canopy to secure the canopy into place.

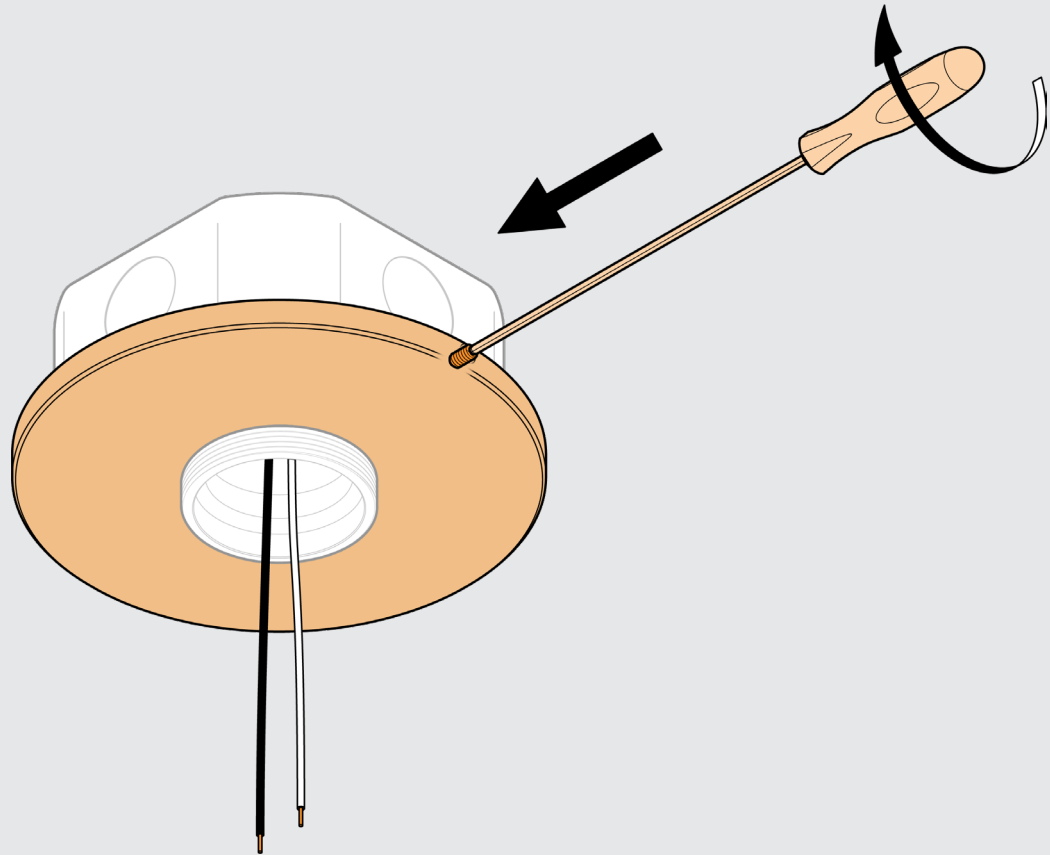

9

---

Travel the wires from the  
fixture through the hang rod.

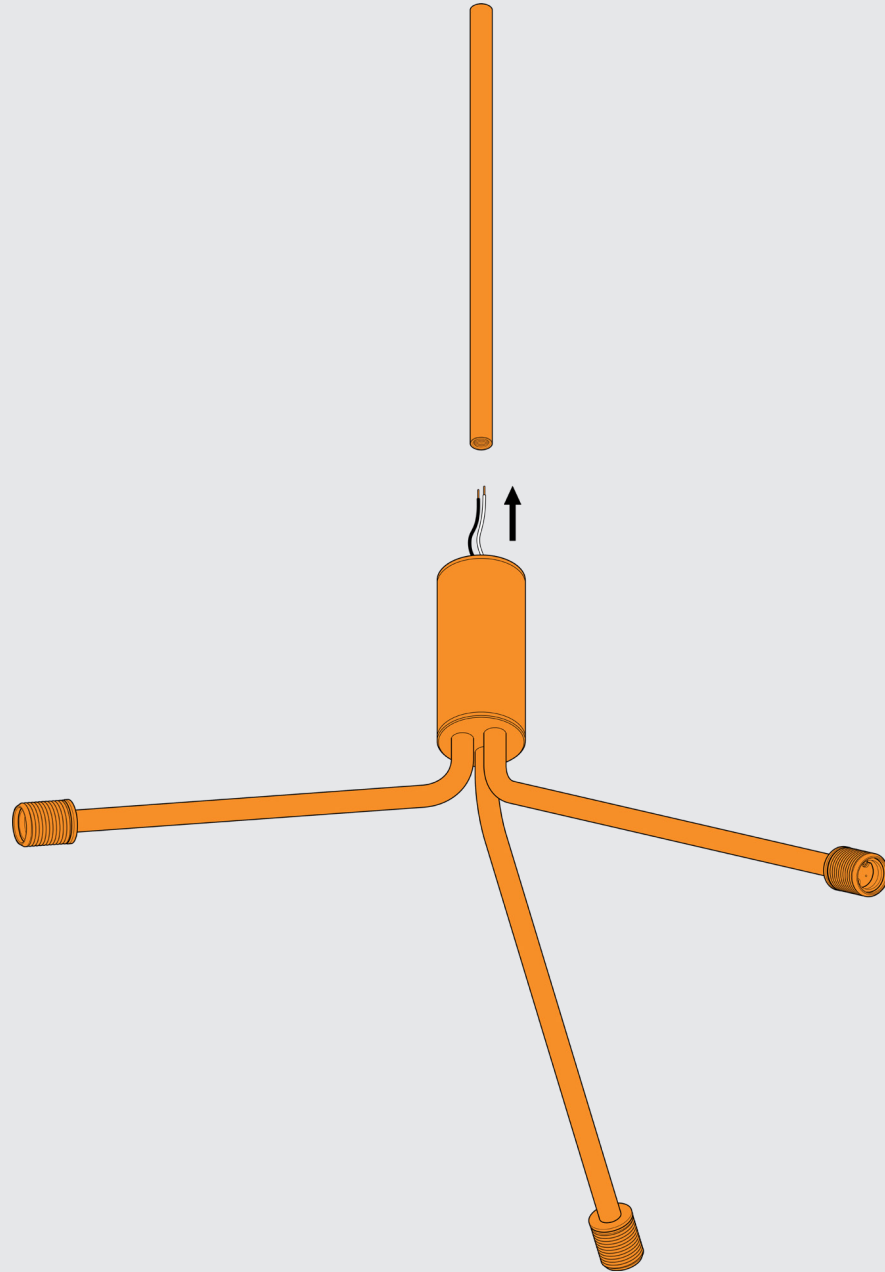

10

—  
Screw the hang rod  
onto the fixture body.

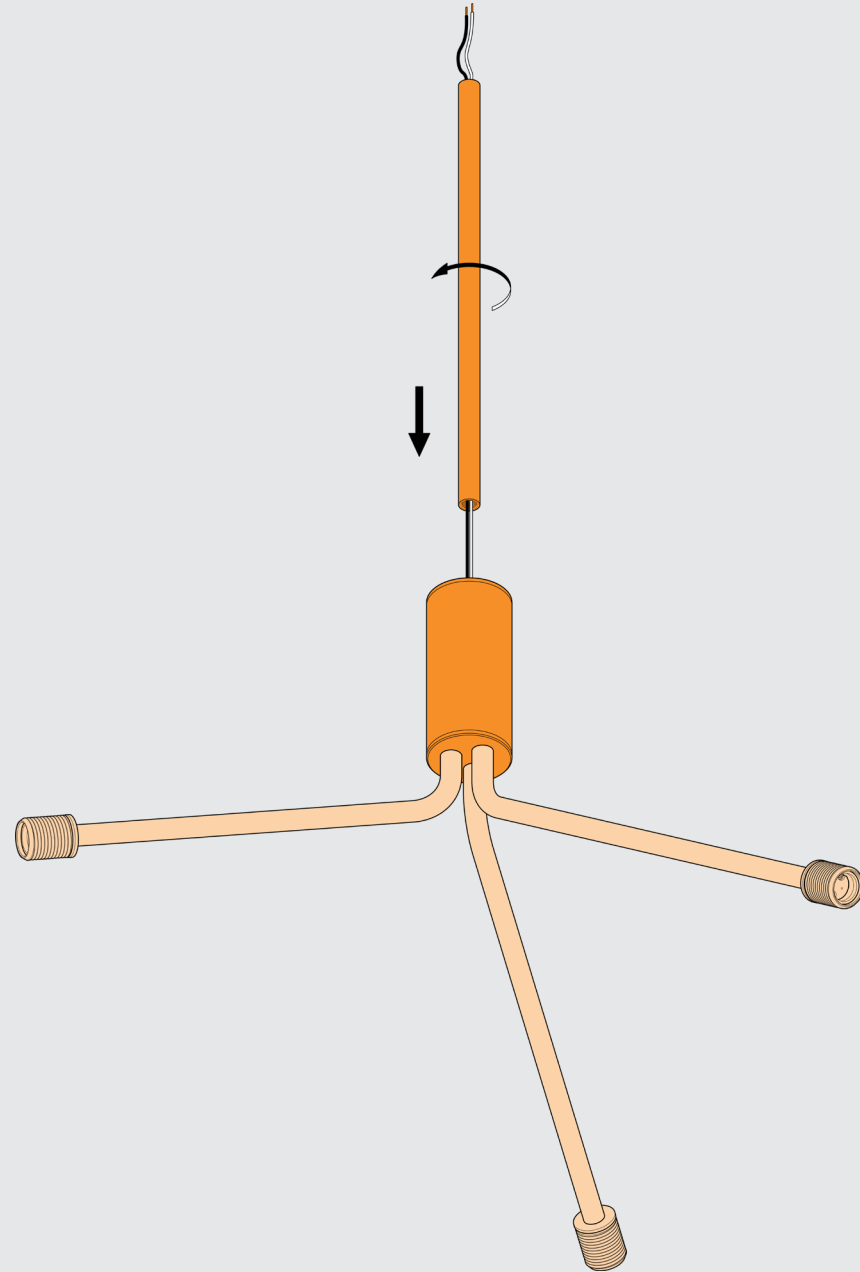

11

---

Carry the lock ring down the hang rod. Travel the wires through the ball joint and then screw the ball joint onto the hang rod.

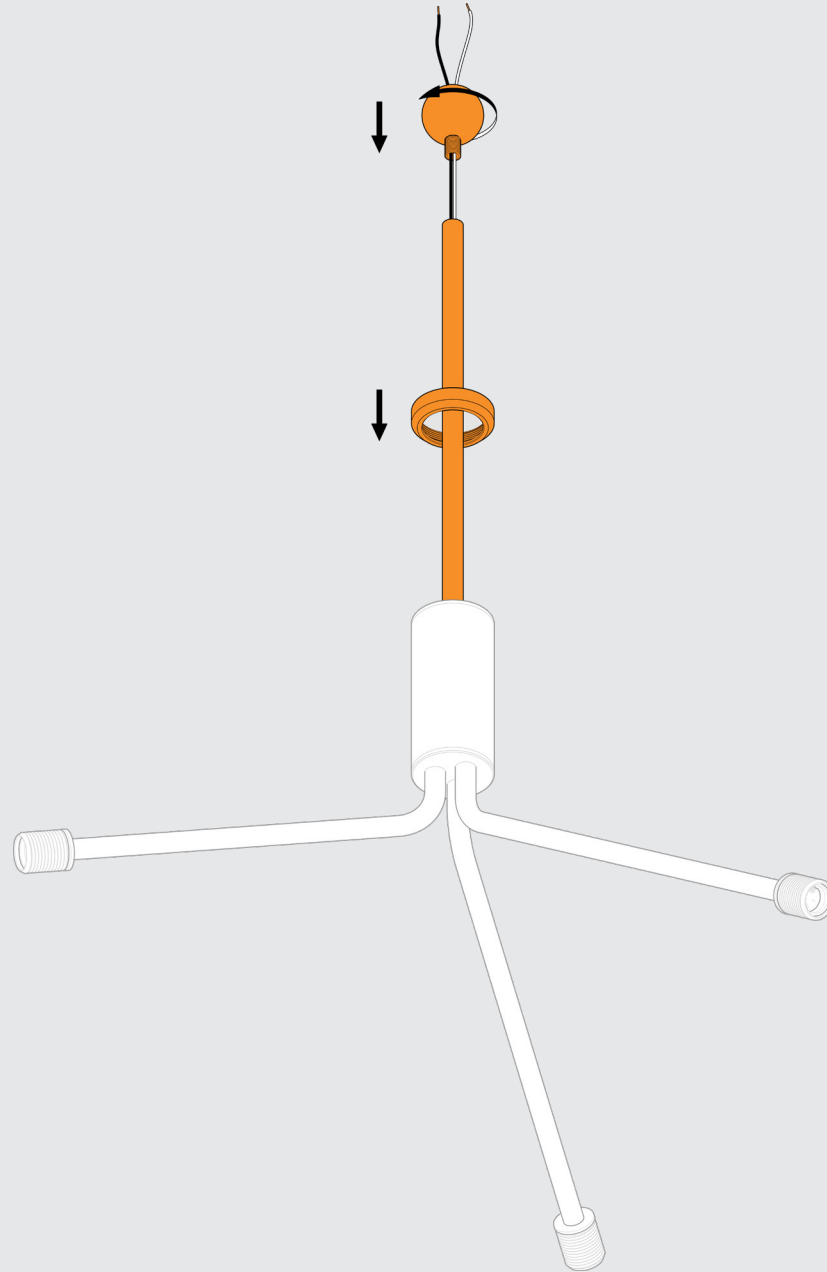

12

---

Connect the wires from the fixture to the wires from the junction box using wire nuts.

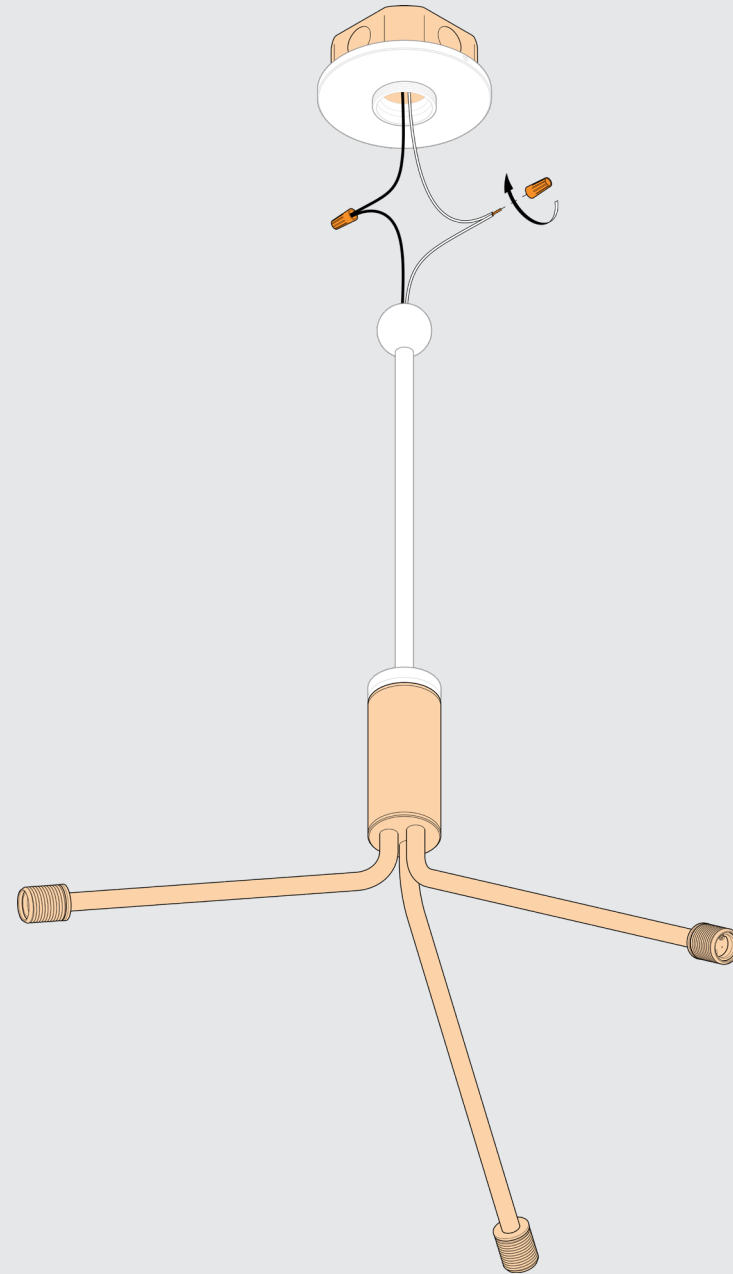

13

---

Carry the fixture up and insert the wires inside the junction box. Place the ball joint inside the adapter and hold in place. Then, carry up and screw the lock ring back onto the adapter to secure the fixture into place.

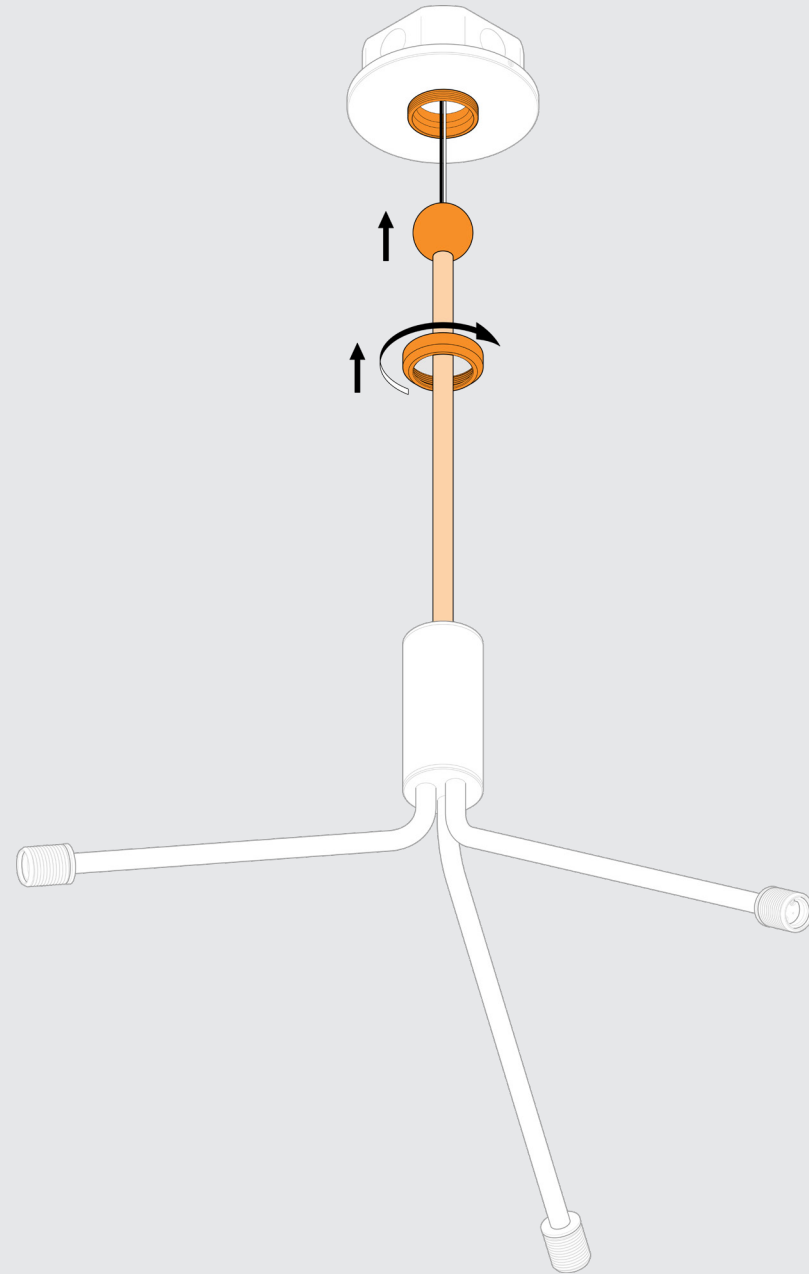

14

Insert the light bulbs into the fixture sockets.

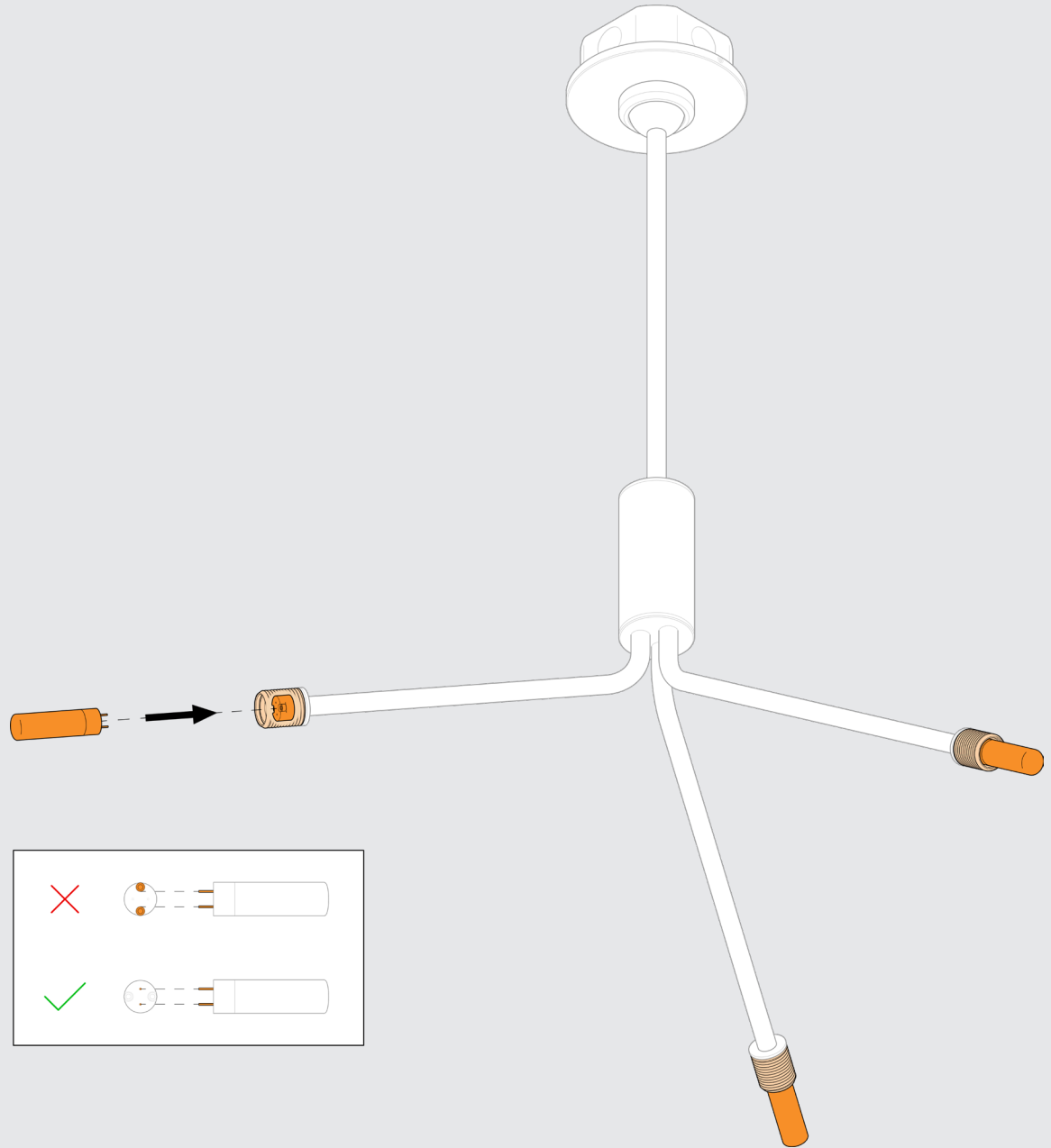

15

---

Screw the glass onto  
the socket Covers.

**CAUTION:** Align threads  
properly for a smooth  
rotation before twisting  
to avoid jamming. **Do not  
overtighten the glass.**

