

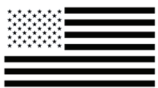

# Bastion Sconce Long

INSTALLATION GUIDE



HANDMADE  
IN U.S.A.



WEAR GLOVES  
DURING INSTALL

**FRAGILE FINISHES**

**DANGER:** ELECTRIC SHOCK RISK. TURN OFF ELECTRICAL POWER BEFORE BEGINNING INSTALLATION AND USE CAUTION WHEN INSTALLING.



+1 212 334 7333

[www.alliedmaker.com](http://www.alliedmaker.com) • [sales@alliedmaker.com](mailto:sales@alliedmaker.com)



1



Inspect Contents

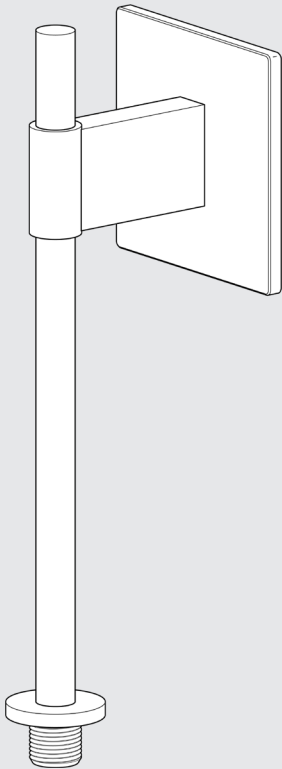

Fixture



Light Bulb



2x Machine Screw

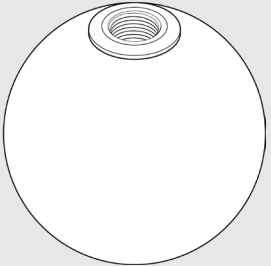

Glass

Terminology

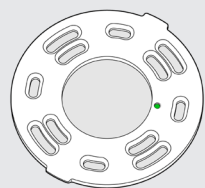

Universal Backplate



Set Screw



1/16 Hex Screwdriver

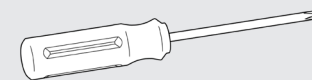

Phillips Screwdriver  
(Not Included)

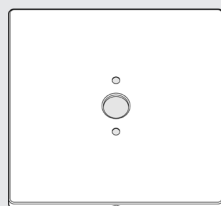

Backplate



Fixture Socket  
&  
Socket Cover

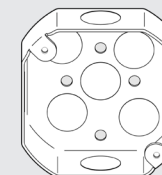

Junction Box  
(Not Included)

3

—  
Preparation

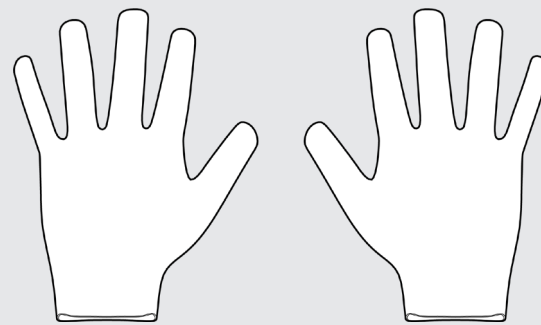

Nitrile Gloves

4

---

Using a 1/16 hex screwdriver, loosen the set screw on the backplate and remove the universal backplate.

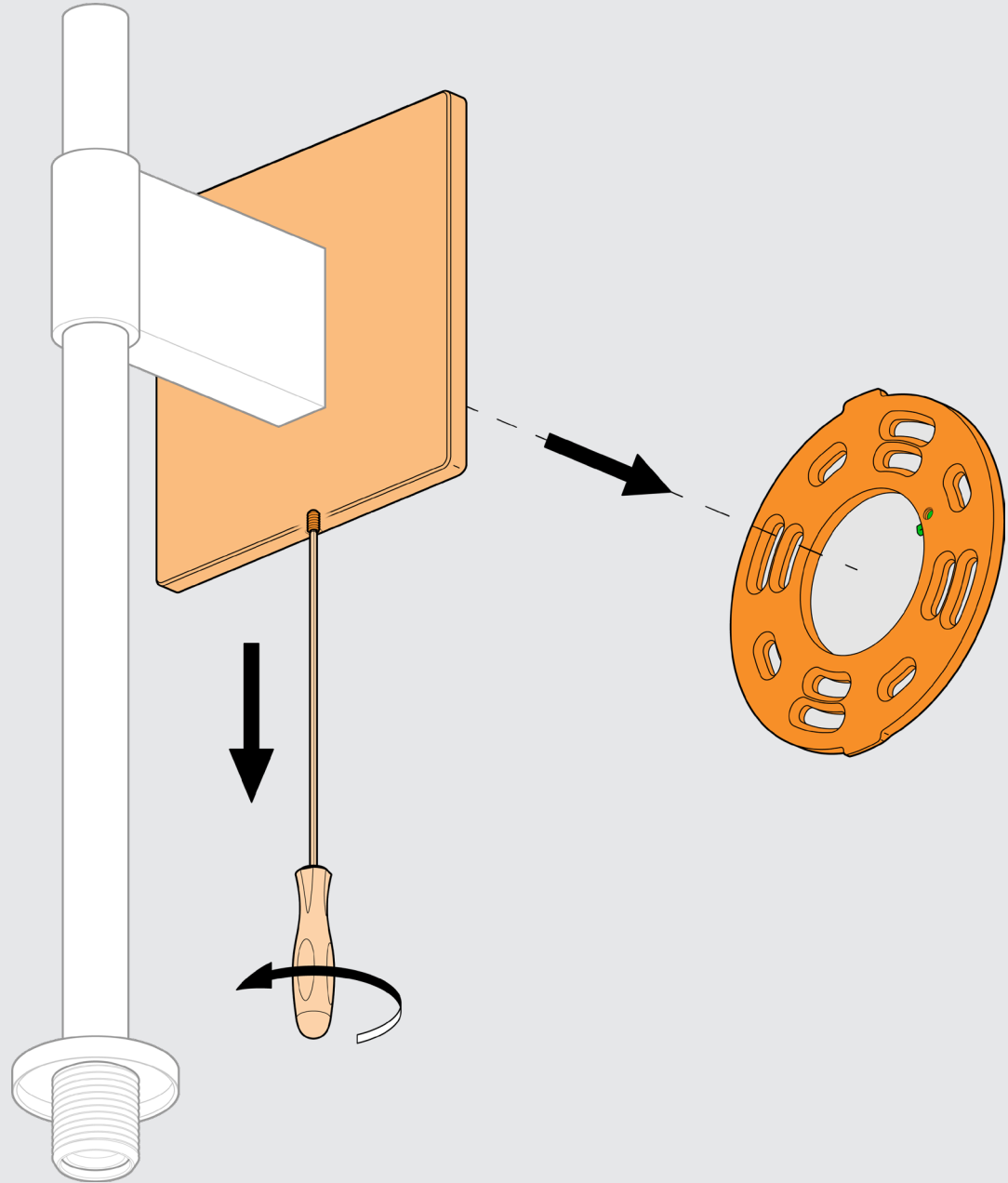

5

Do Not Overtighten  
Machine Screws

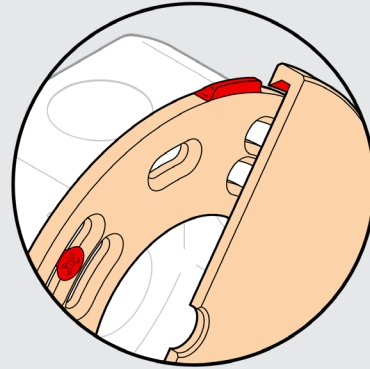

Min. 10.00°

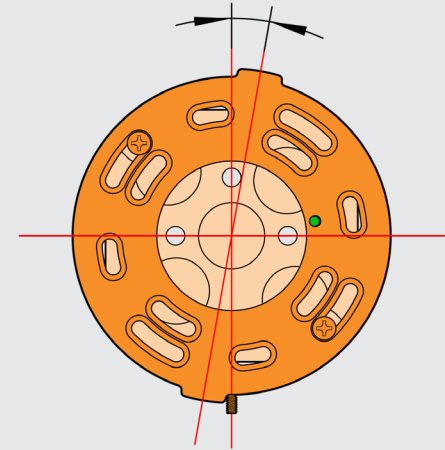

Mount the universal backplate onto the junction box using the provided machine screws.

**NOTE:** Make sure the two tabs on the universal backplate are rotated to a minimum of 10° from vertical alignment. This will ensure the set screw has enough space to fully secure the backplate and universal backplate into place.

**CAUTION:** Do not overtighten the machine screws. Overtightening will prevent the two tabs on the universal backplate from engaging with the channel inside the backplate.

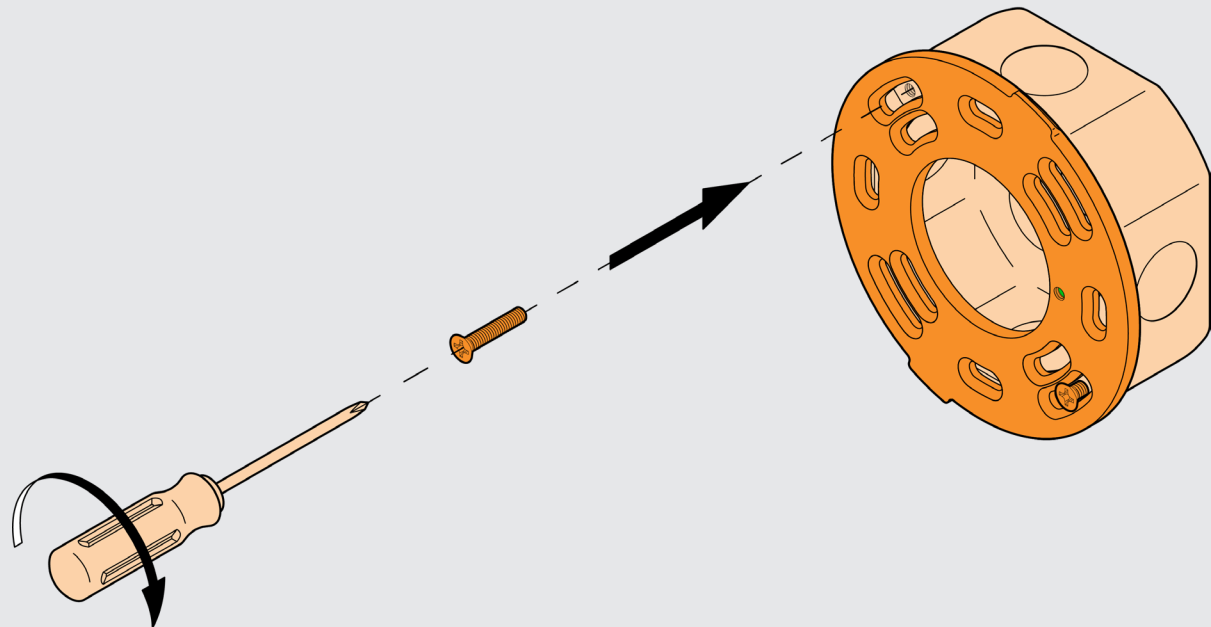



7

---

Align the tabs on the universal backplate with the tab openings on the backplate. Then, place the fixture backplate over the universal backplate and rotate the fixture to the desired position.

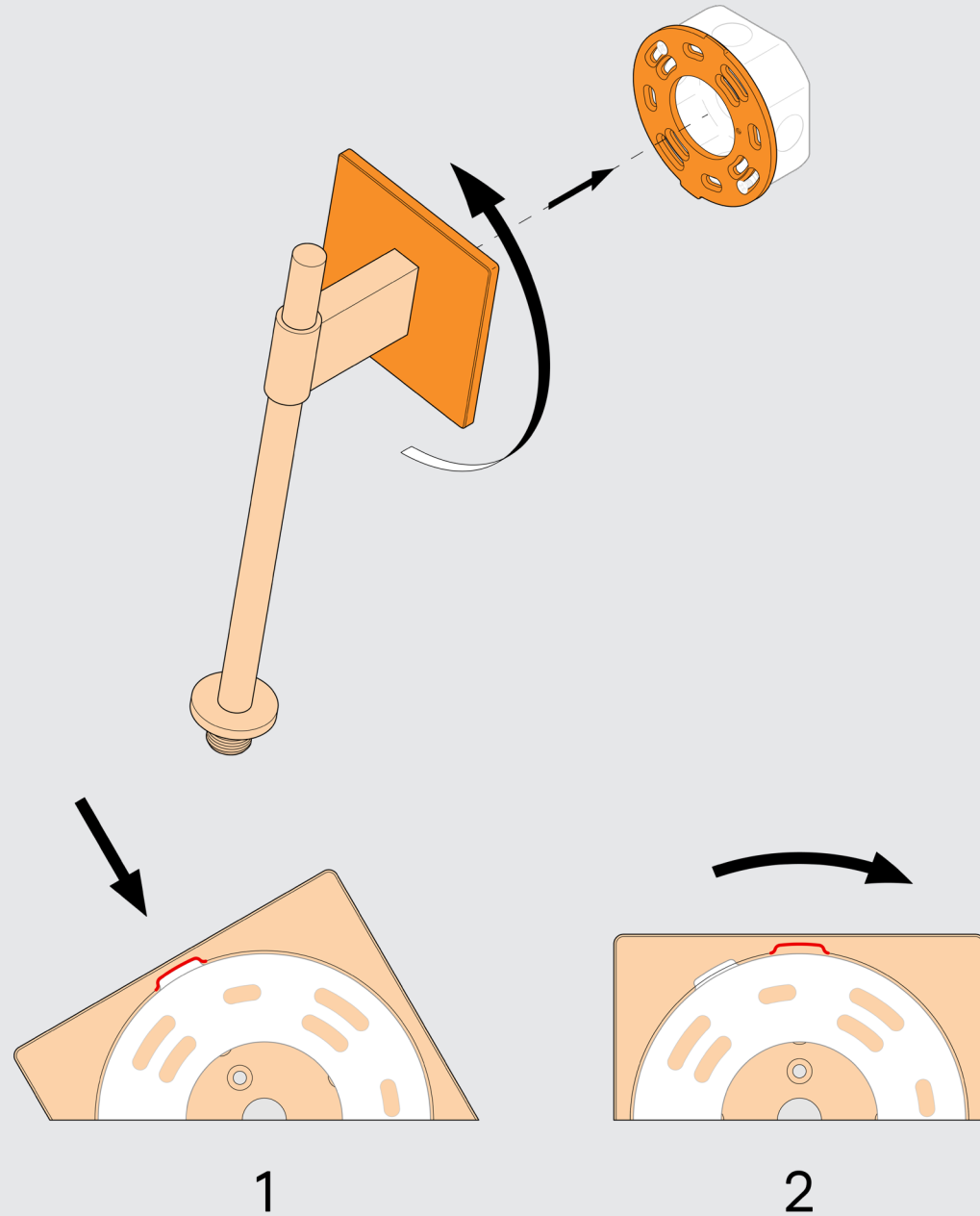

8

---

Once the fixture is set into place, tighten the set screw on the fixture backplate to secure the fixture into place.

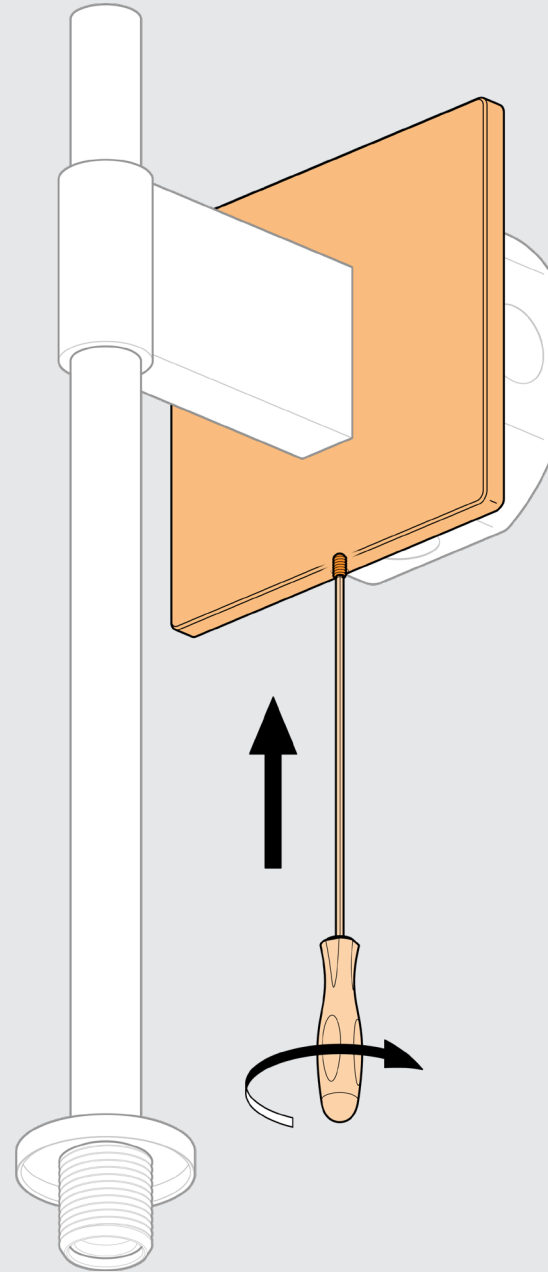

9

—  
Insert the light bulb  
into the fixture socket.

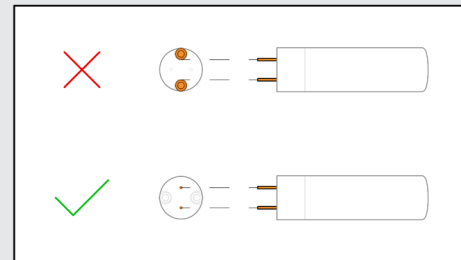
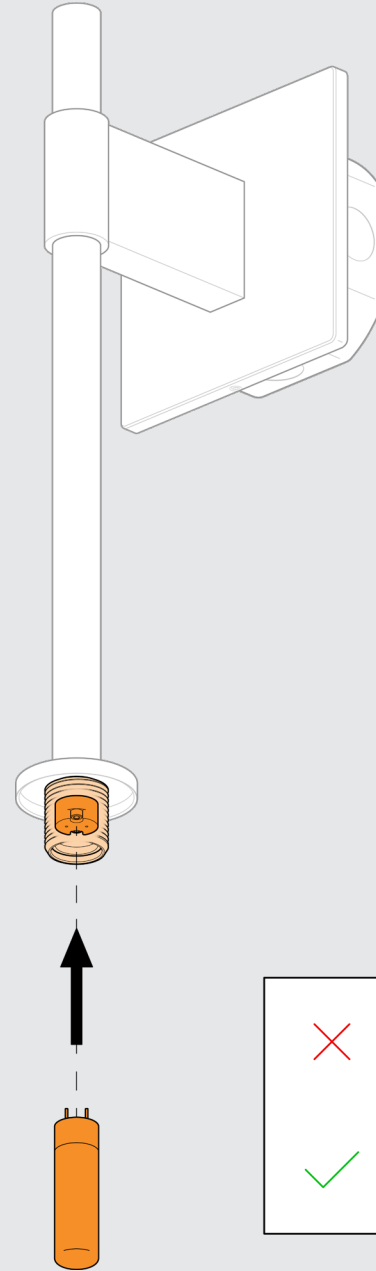

# 10

---

Screw the glass onto the socket cover.

**CAUTION:** Align threads properly for a smooth rotation before twisting to avoid jamming. **Do not overtighten the glass.**

