



ALLIED MAKER

MADE IN NEW YORK

Monoscope Nautilus Sconce

Installation Guide

212-334-7333

help@alliedmaker.com

LIVING FINISHES



Wear Gloves!



THIS PRODUCT MUST BE INSTALLED IN ACCORDANCE WITH THE APPLICABLE
INSTALLATION CODE BY A PERSON FAMILIAR WITH THE CONSTRUCTION AND
OPERATION OF THE PRODUCT AND HAZARDS INVOLVED

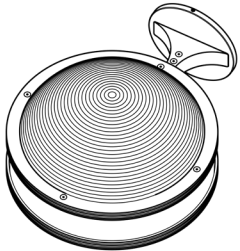
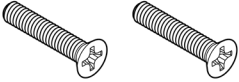

Contents Included

 <p>Lighting Fixture</p>	 <p>2x Phillips Screw</p>	 <p>1/16 Hex Driver</p>
---	---	--

1

Using the provided 1/16 hex driver ①
loosen the set screw ②
in the canopy ③

Remove the backplate ④

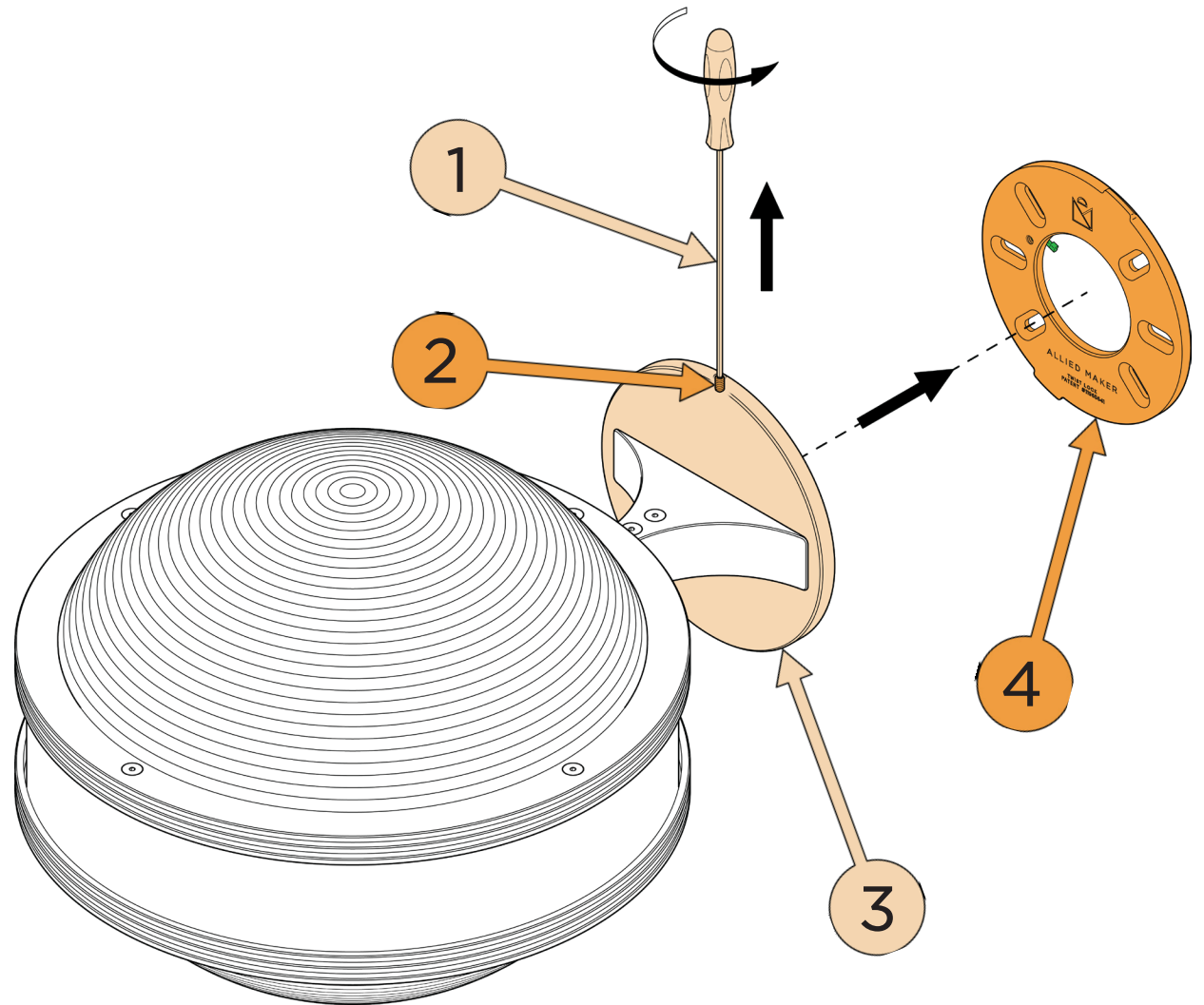

2

Mount the backplate ① onto the junction box ② using the provided phillips screws ③

NOTE: Make sure the two tabs on the backplate are rotated to a minimum of 20° from the intended mounting alignment. This will ensure the set screw has enough space to fully secure the canopy and backplate into place.

CAUTION: Do not overtighten the phillips screws. Overtightening will prevent the two tabs on the backplate from engaging with the channel inside the canopy.

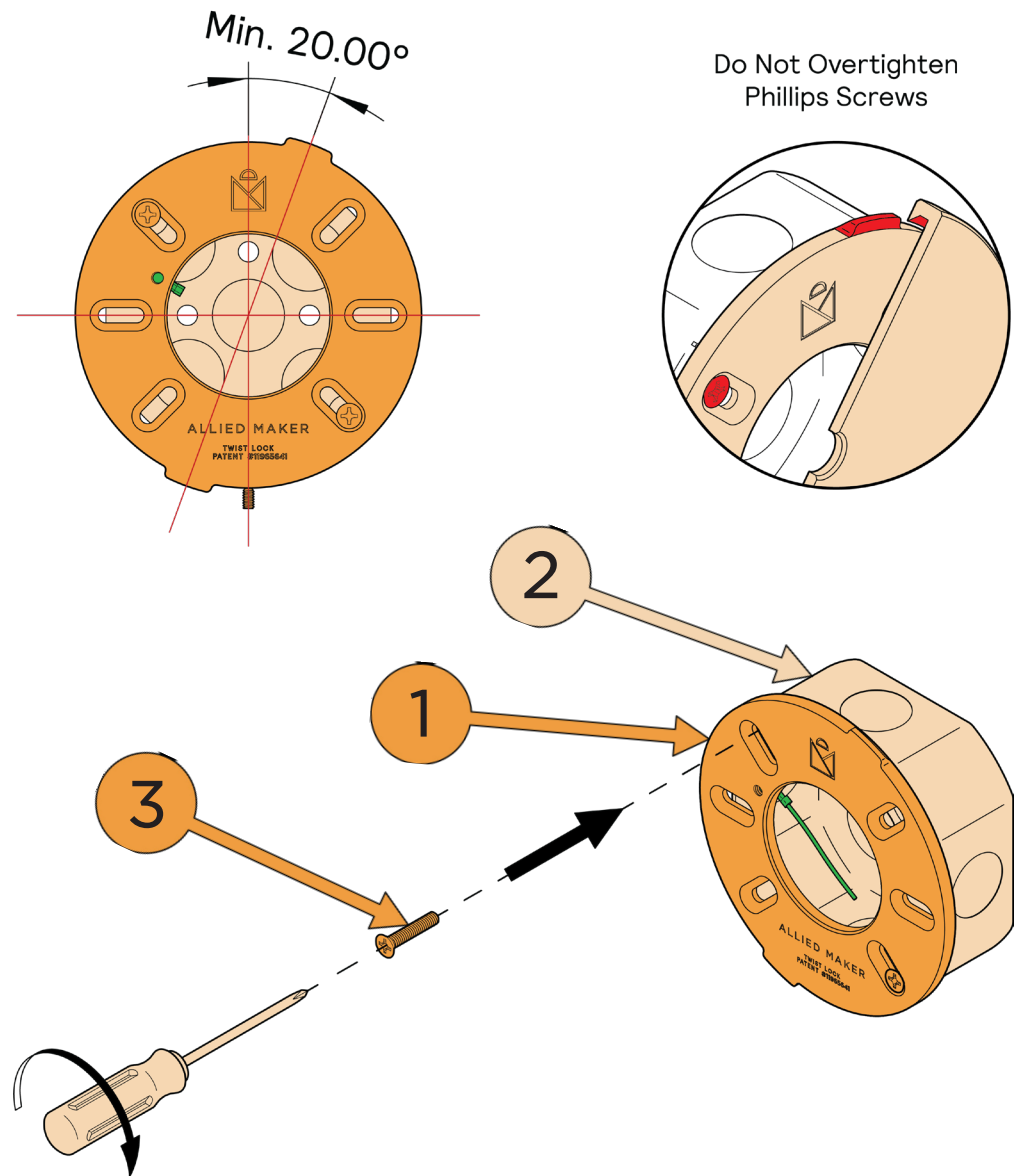

3

Connect the wires from the lighting fixture ① with the wires from the junction box ② using wire nuts ③

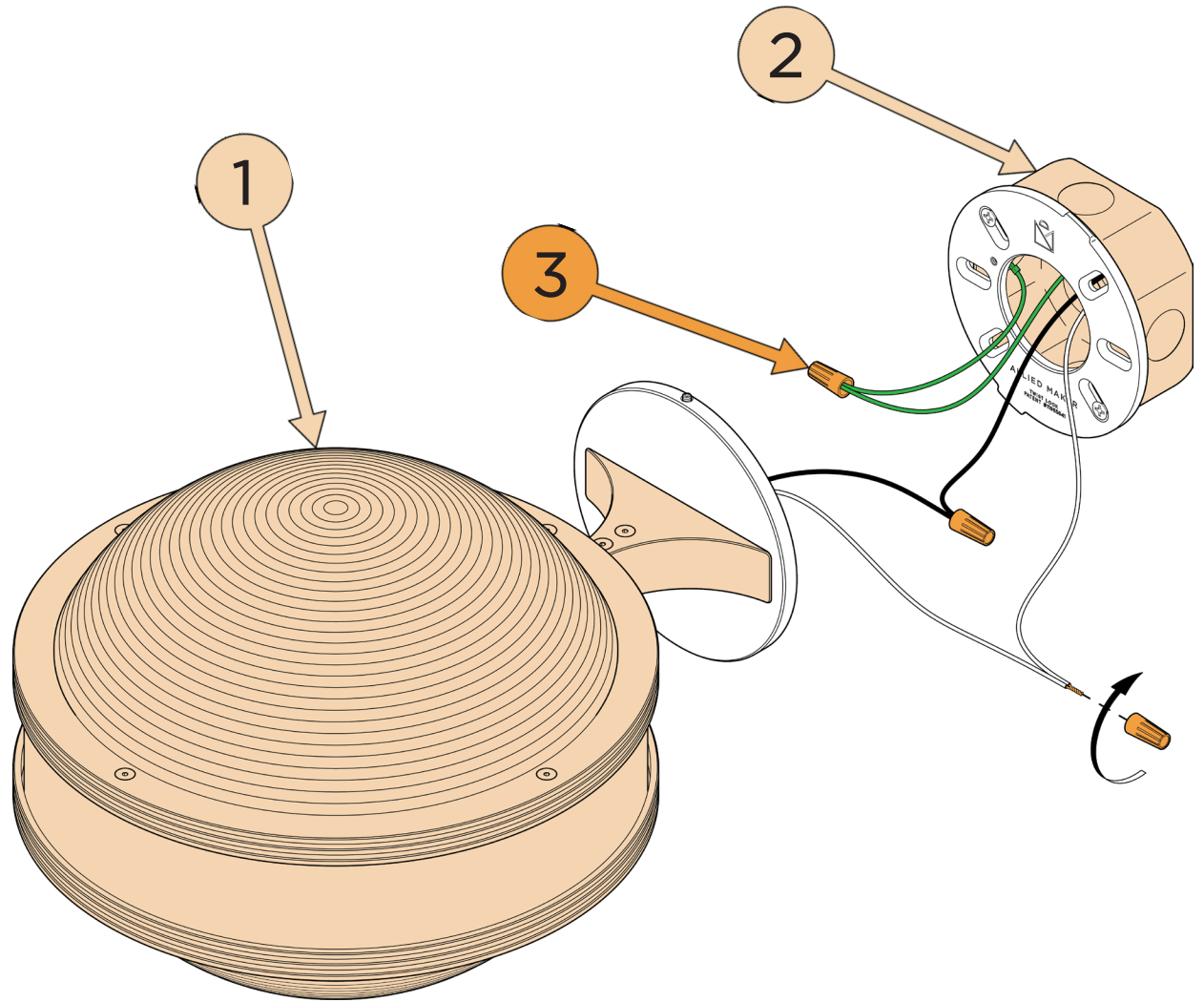

4

Align the tabs on the **backplate** ① with the tab openings on the **canopy** ②

Place the **canopy** ② over the **backplate** ① and rotate the **canopy** ② to the desired position.

NOTE: Make sure the brass caps on the shades face upward and not downward prior to mounting.

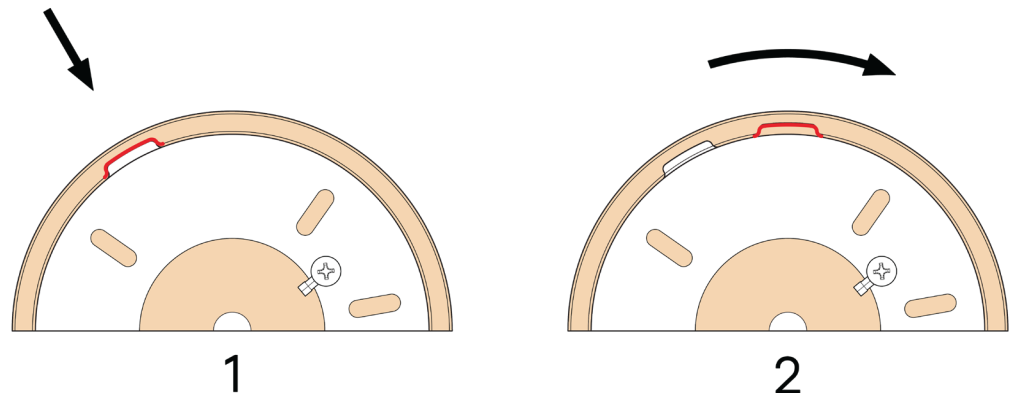
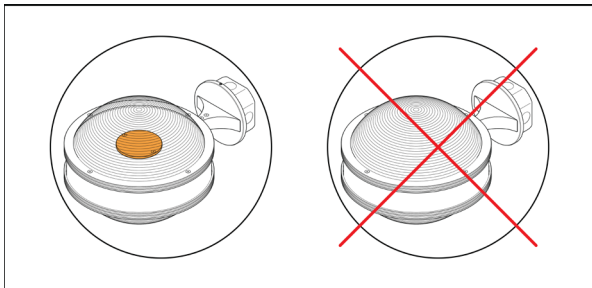
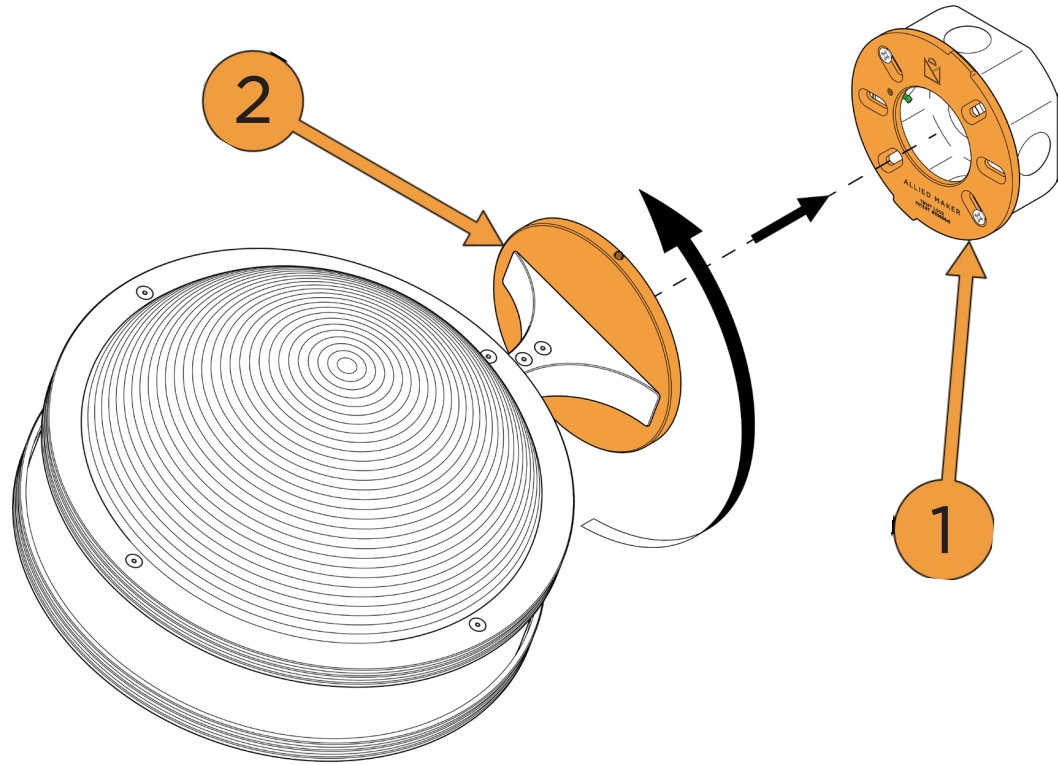

5

Using the 1/16 hex driver ①
tighten the set screw ②
in the canopy ③
to secure the canopy ③
into place.

