



ALLIED MAKER

MADE IN NEW YORK

## Gesso Sconce

4" Junction Box Mounting  
Installation Guide

212-334-7333

[help@alliedmaker.com](mailto:help@alliedmaker.com)

**LIVING FINISHES**

Wear Gloves!



THIS PRODUCT MUST BE INSTALLED IN ACCORDANCE WITH THE APPLICABLE  
INSTALLATION CODE BY A PERSON FAMILIAR WITH THE CONSTRUCTION AND  
OPERATION OF THE PRODUCT AND HAZARDS INVOLVED



# Contents Included

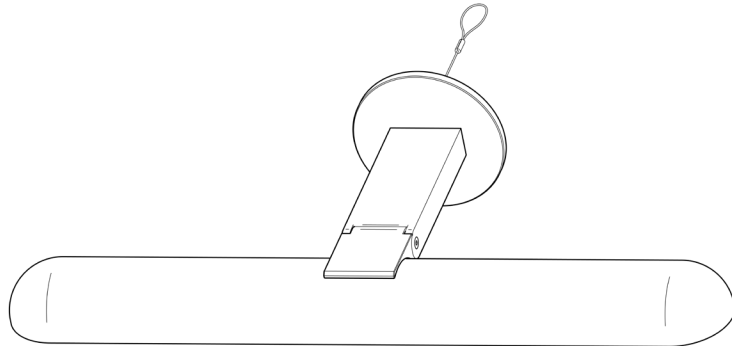

Lighting Fixture

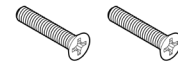

2x Phillips Screw



1/16 Hex Driver

# 1

Using the provided hex driver ①  
loosen the set screw ②  
from the canopy ③

Remove the backplate ④

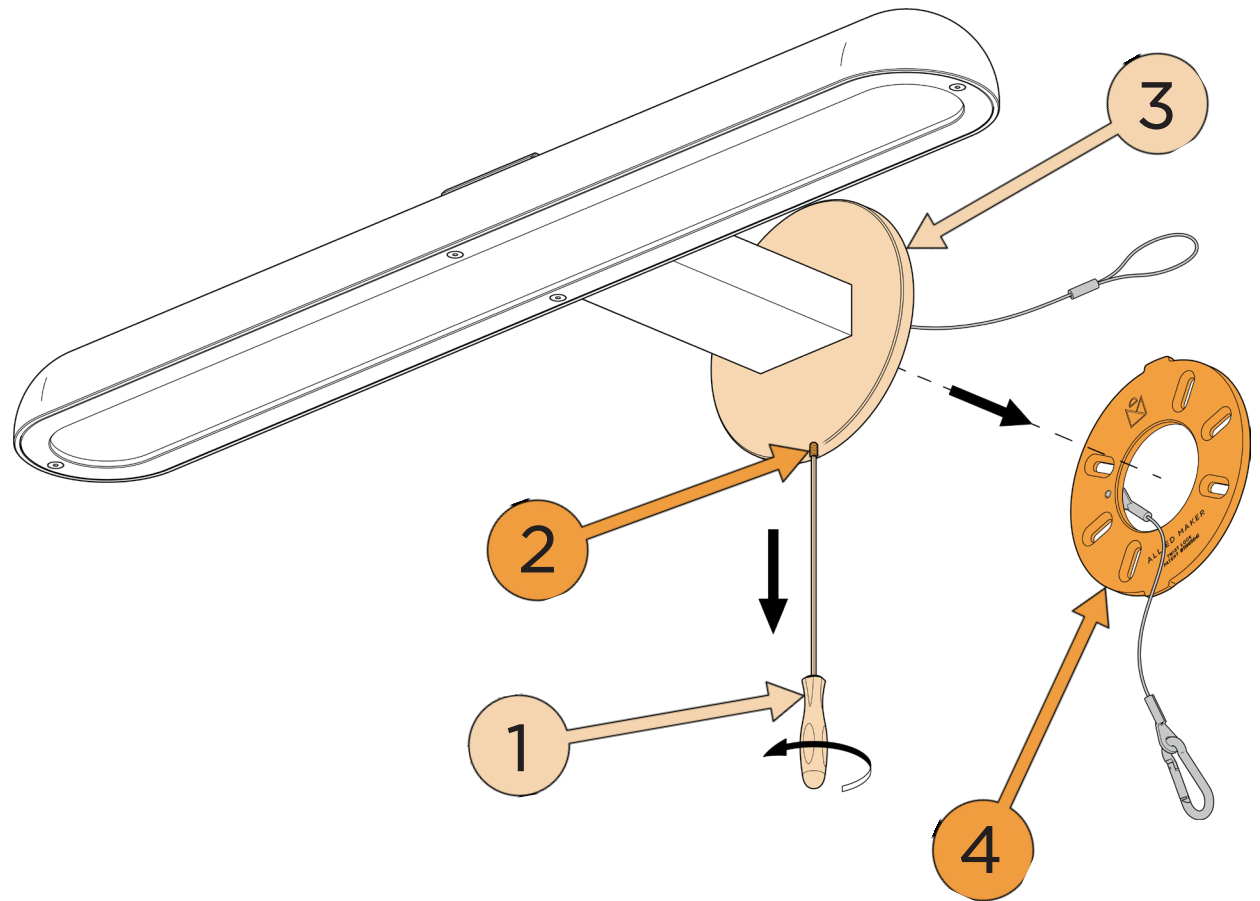

# 2

Mount the backplate ① onto the junction box ② using the provided phillips screws ③

**NOTE:** Make sure the two tabs on the backplate are rotated to a minimum of 20° from the intended mounting alignment. This will ensure the set screw has enough space to fully secure the canopy and backplate into place.

**CAUTION:** Do not overtighten the phillips screws. Overtightening will prevent the two tabs on the backplate from engaging with the channel inside the canopy.

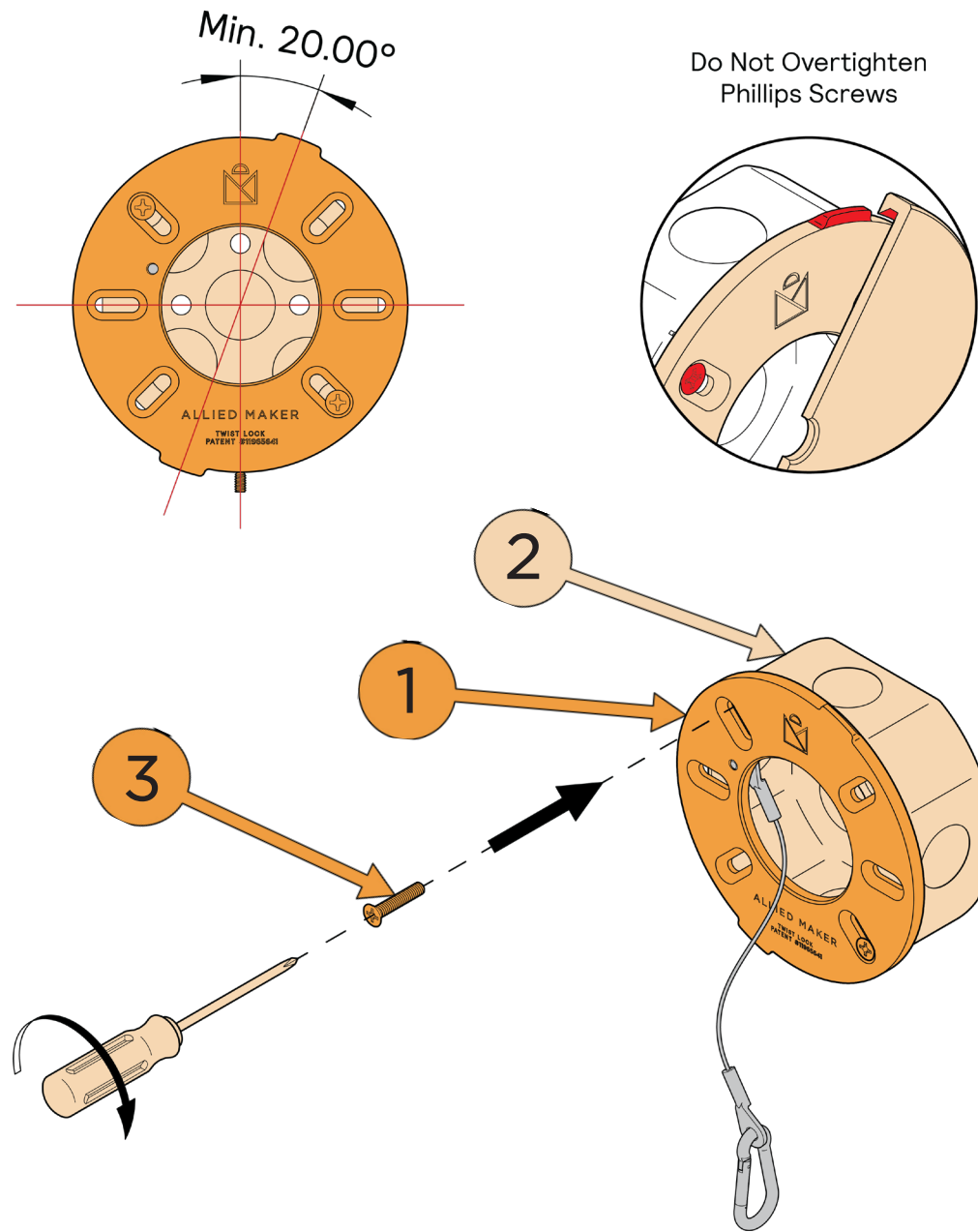

# 3

Connect the ground wire from the **lighting fixture** ① with the ground wire from the **junction box** ② using a **wire nut** ③

Connect the lanyard ④ loop from the **lighting fixture** ① with the **carabiner** ⑤ on the **backplate** ⑥

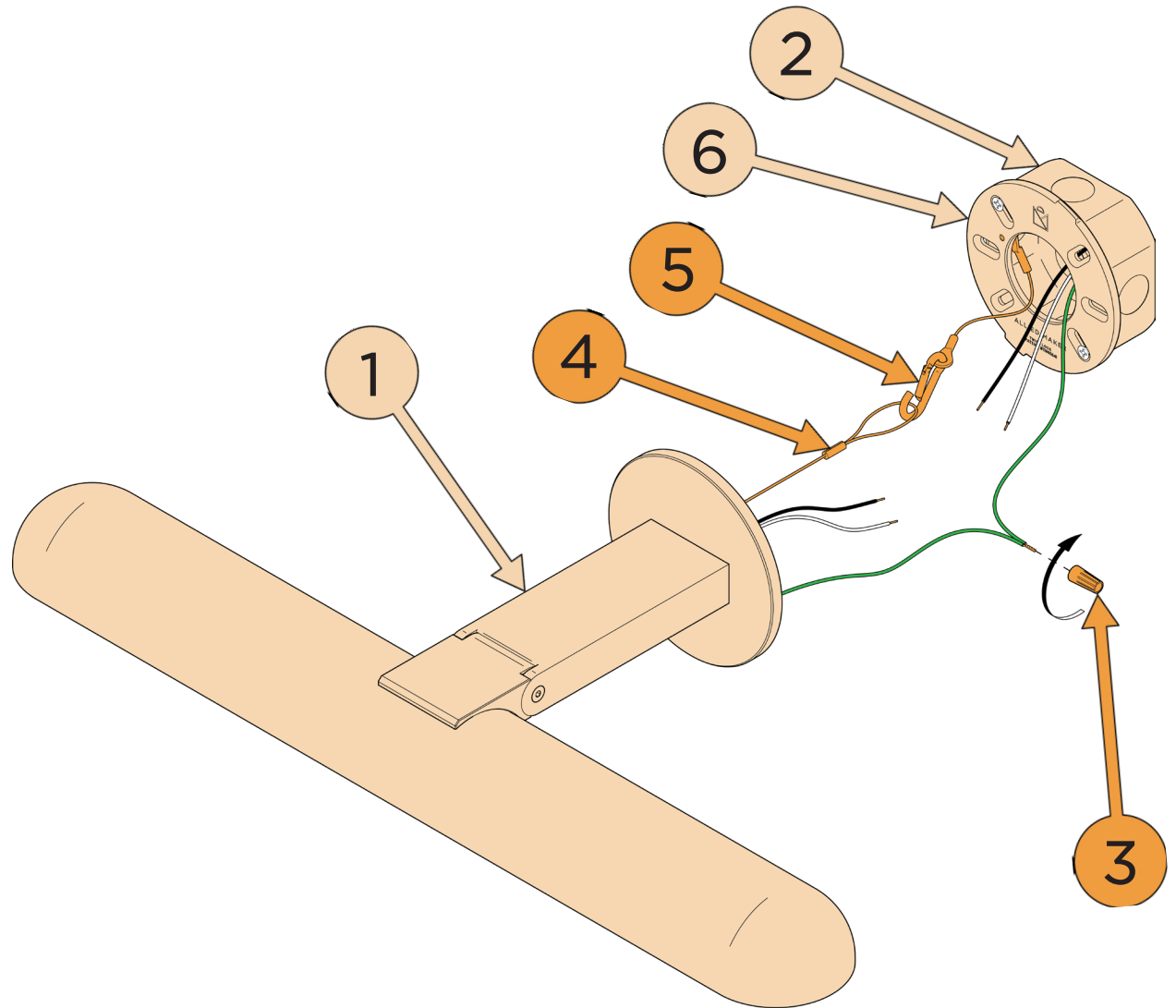

# 4

Connect the wires from the **lighting fixture** ① with the wires from the **junction box** ② using **wire nuts** ③

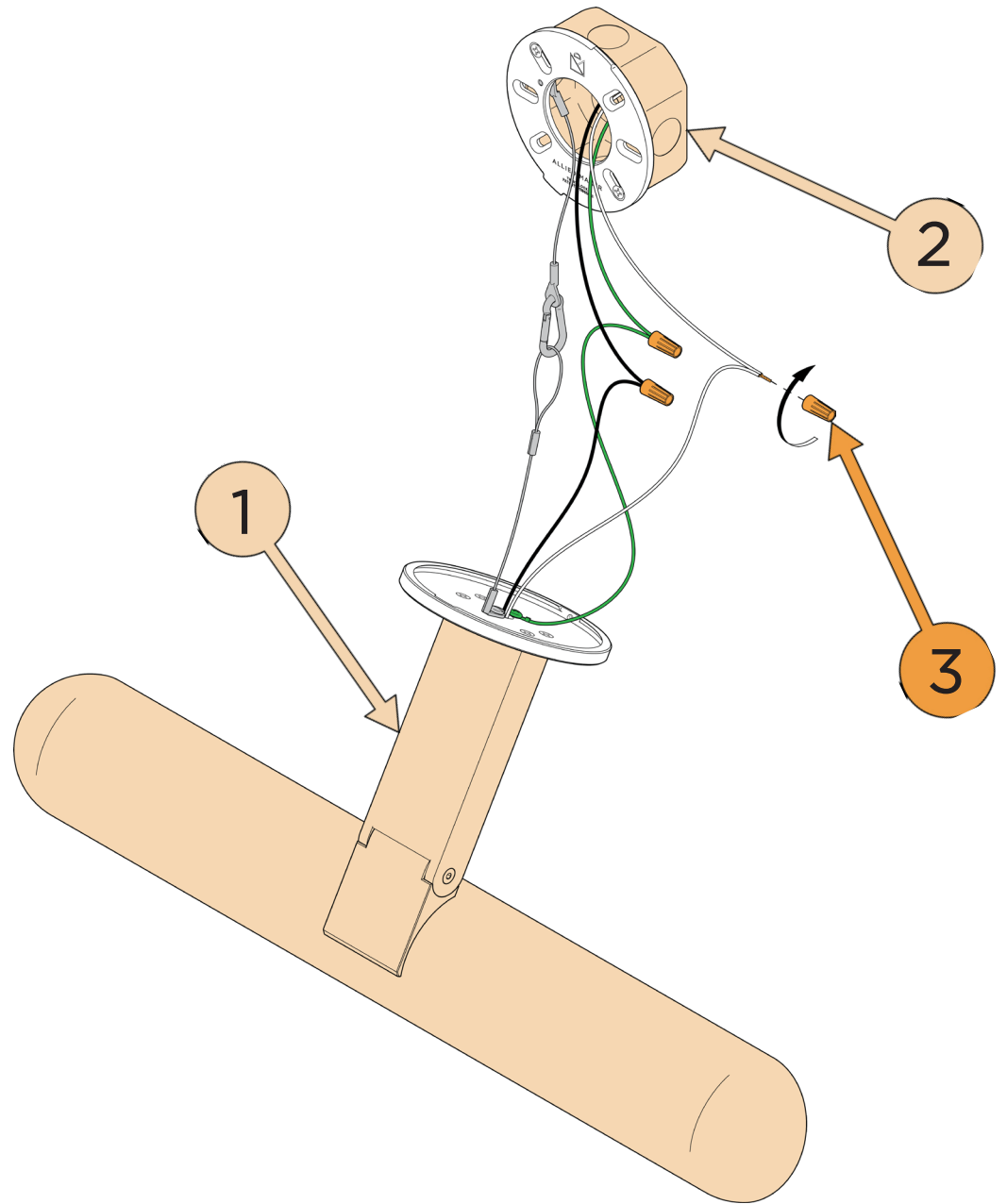

# 5

Align the tabs on the **backplate** ① with the tab openings on the **canopy** ②

Place the **canopy** ② over the **backplate** ① and rotate the **canopy** ② to the desired position.

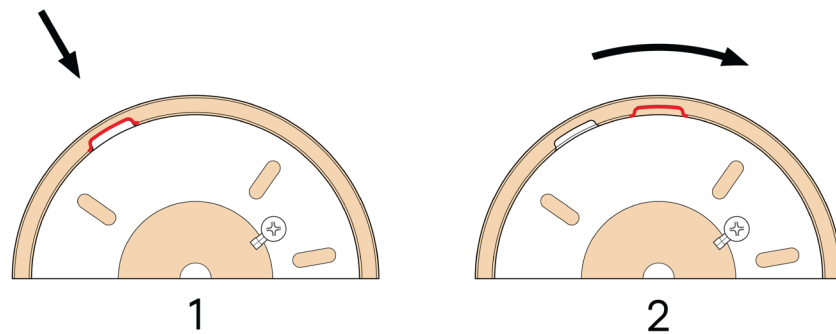
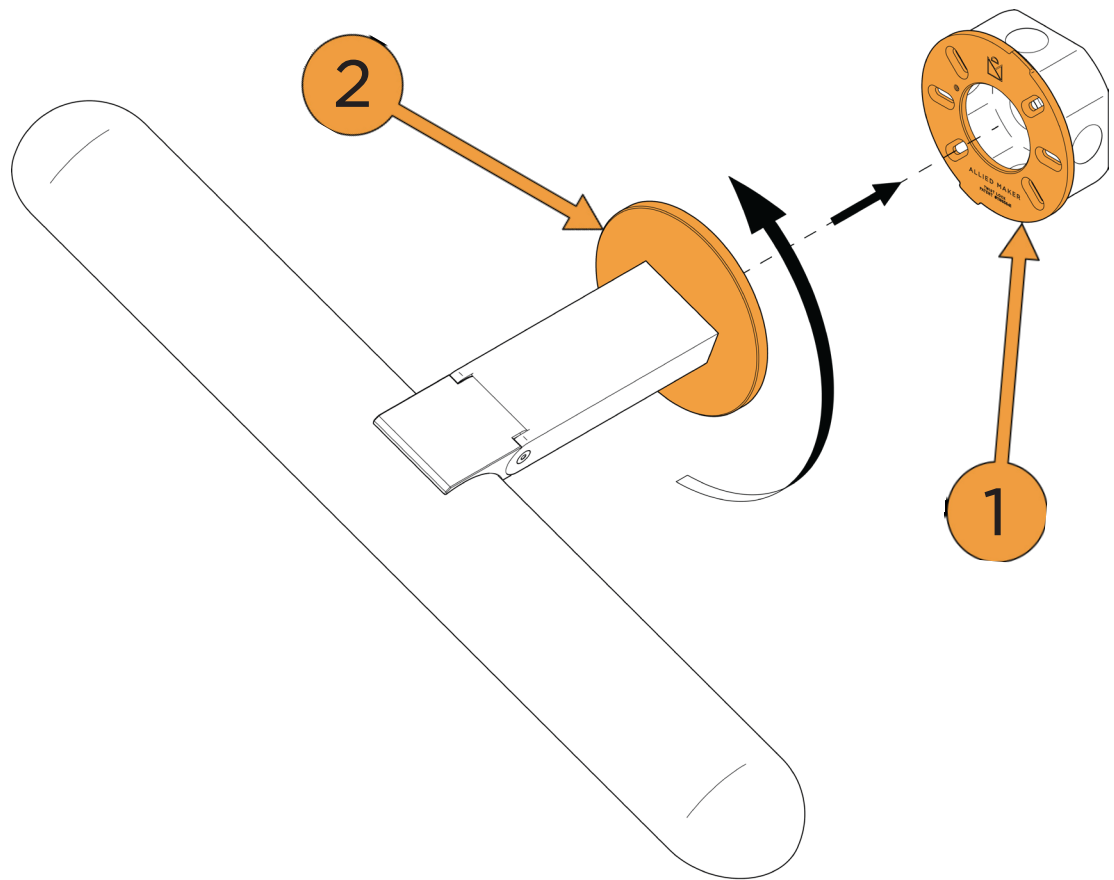



# 6

Using the **hex driver** ① tighten the **set screw** ② in the **canopy** ③ to secure the canopy ③ into place.

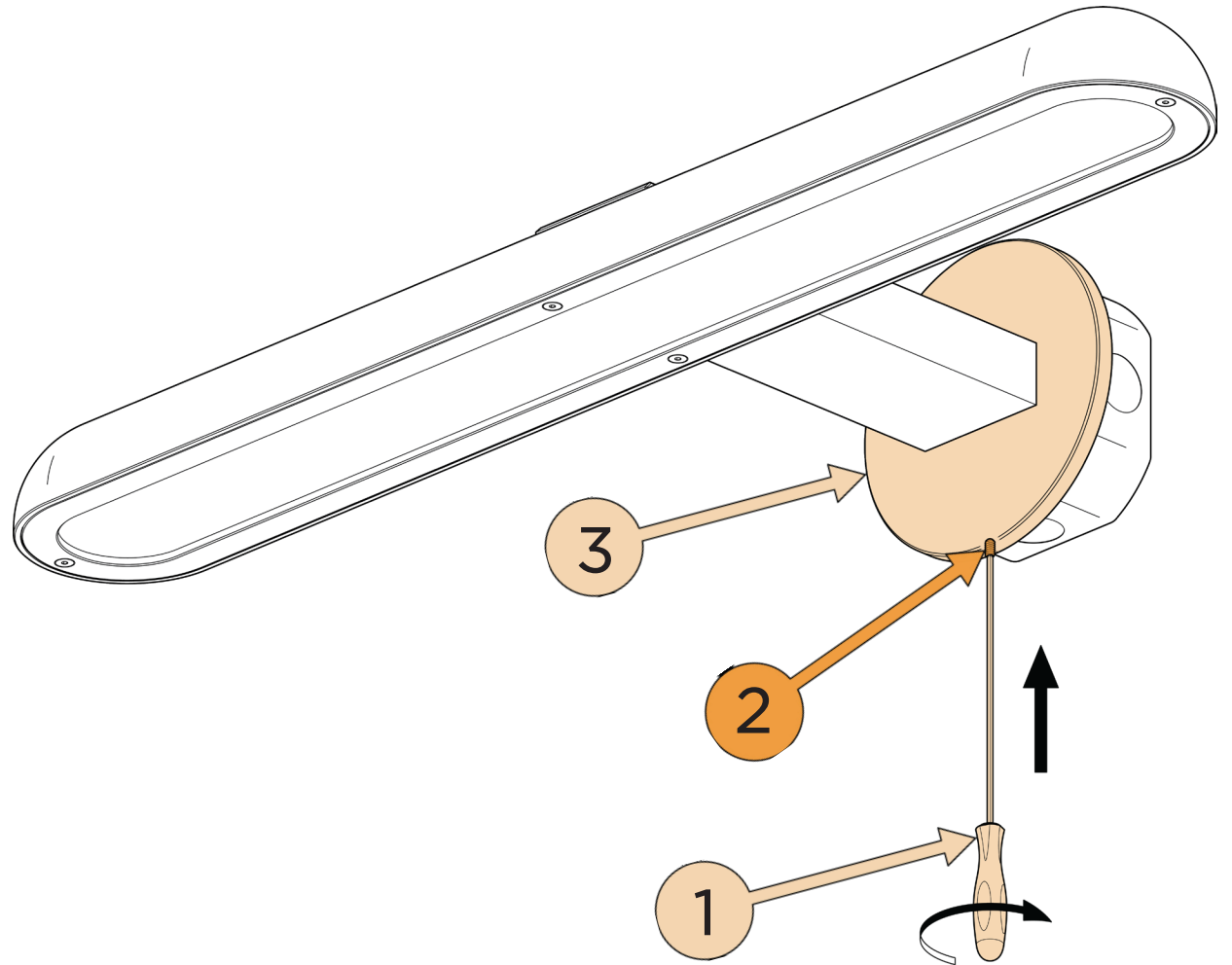





ALLIED MAKER

MADE IN NEW YORK

# Gesso Sconce

Single Gang Junction Box Mounting  
Installation Guide

212-334-7333

[help@alliedmaker.com](mailto:help@alliedmaker.com)

**LIVING FINISHES**

Wear Gloves!



THIS PRODUCT MUST BE INSTALLED IN ACCORDANCE WITH THE APPLICABLE  
INSTALLATION CODE BY A PERSON FAMILIAR WITH THE CONSTRUCTION AND  
OPERATION OF THE PRODUCT AND HAZARDS INVOLVED



# Contents Included

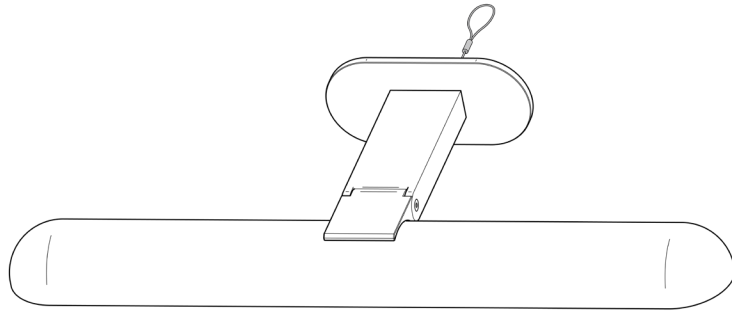

Lighting Fixture

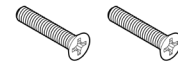

2x Phillips Screw



1/16 Hex Driver

# 1

Using the provided hex driver ①  
loosen the set screw ②  
from the canopy ③

Remove the backplate ④

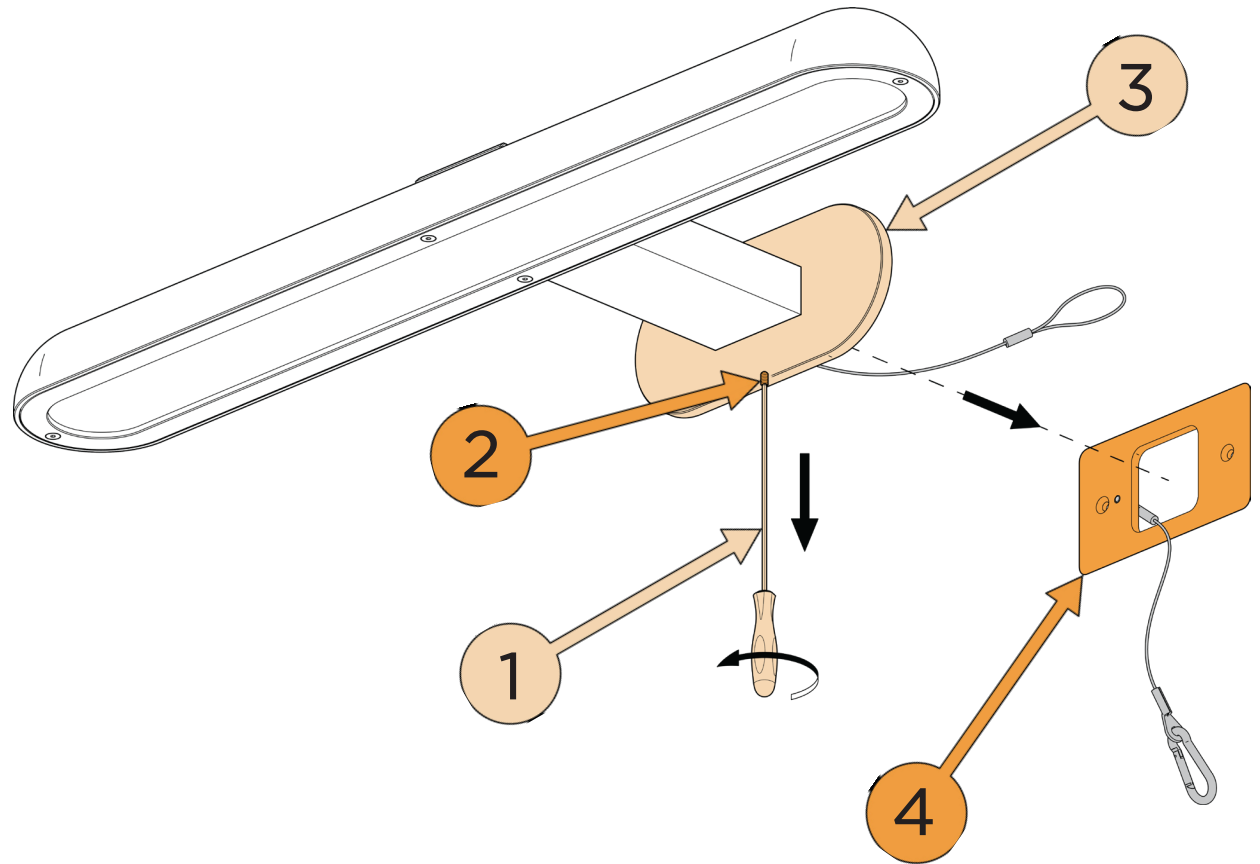

# 2

Mount the backplate ①  
onto the junction box ②  
using the provided phillips screws ③

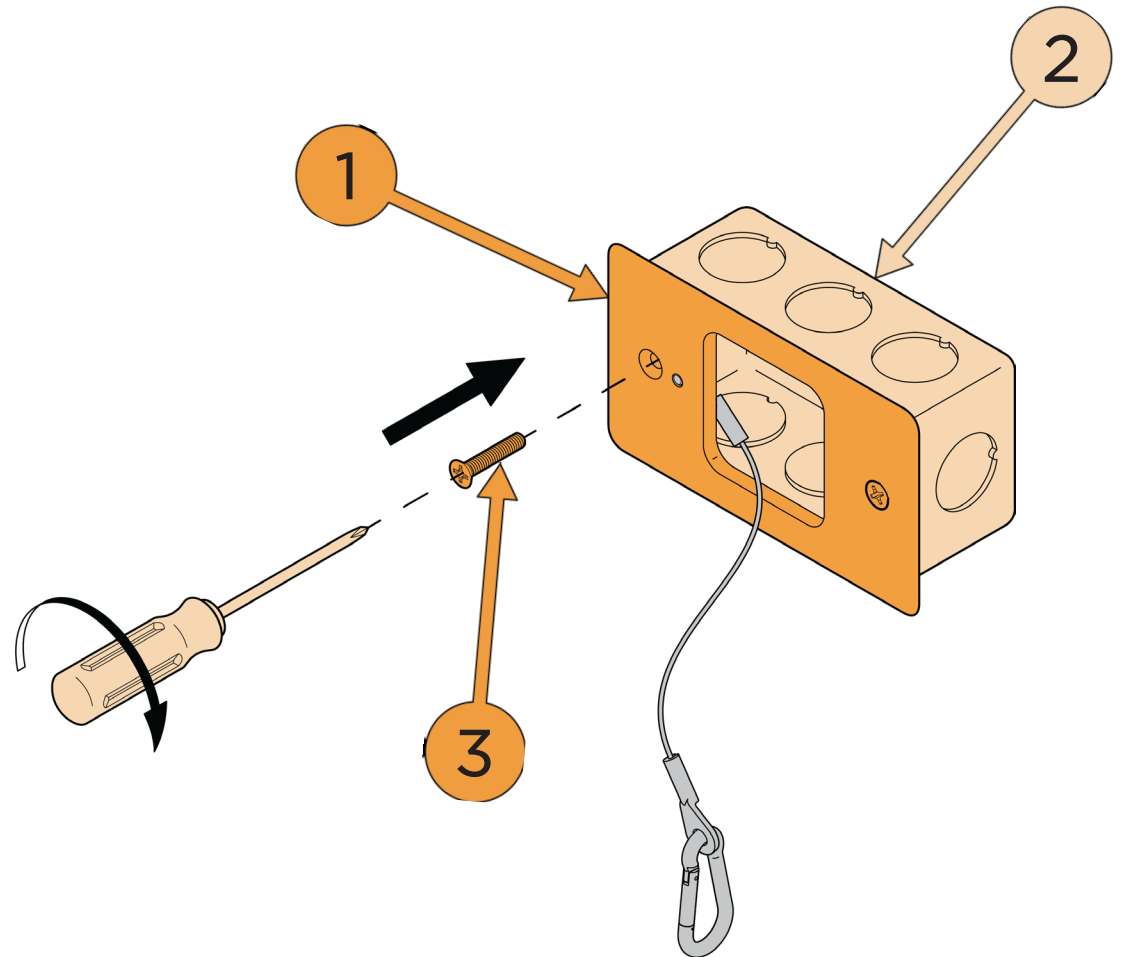

# 3

Connect the ground wire from the **lighting fixture** ① with the ground wire from the **junction box** ② using a **wire nut** ③

Connect the lanyard ④ loop from the **lighting fixture** ① with the **carabiner** ⑤ on the **backplate** ⑥

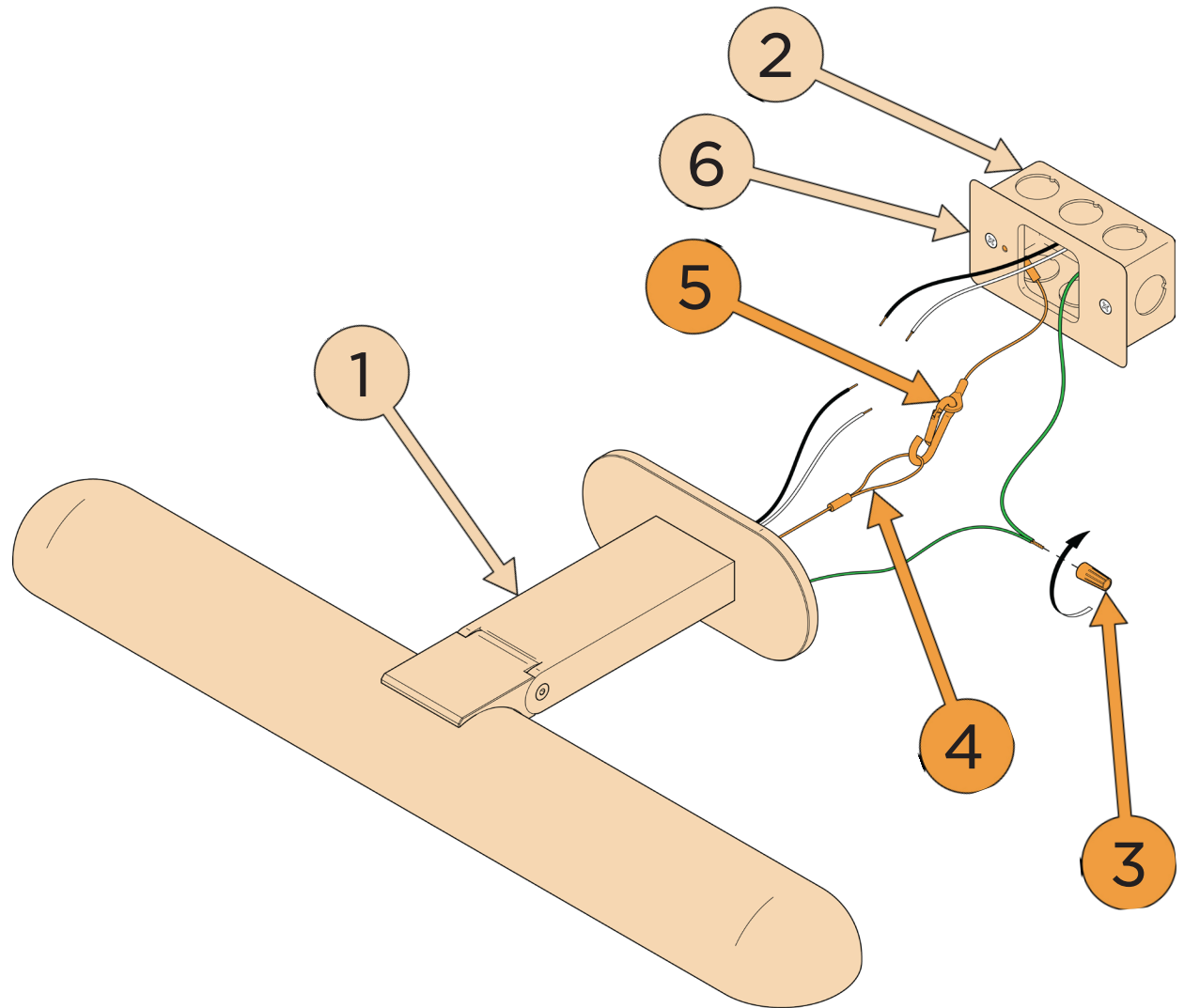

# 4

Connect the wires from the **lighting fixture** ① with the wires from the **junction box** ② using **wire nuts** ③

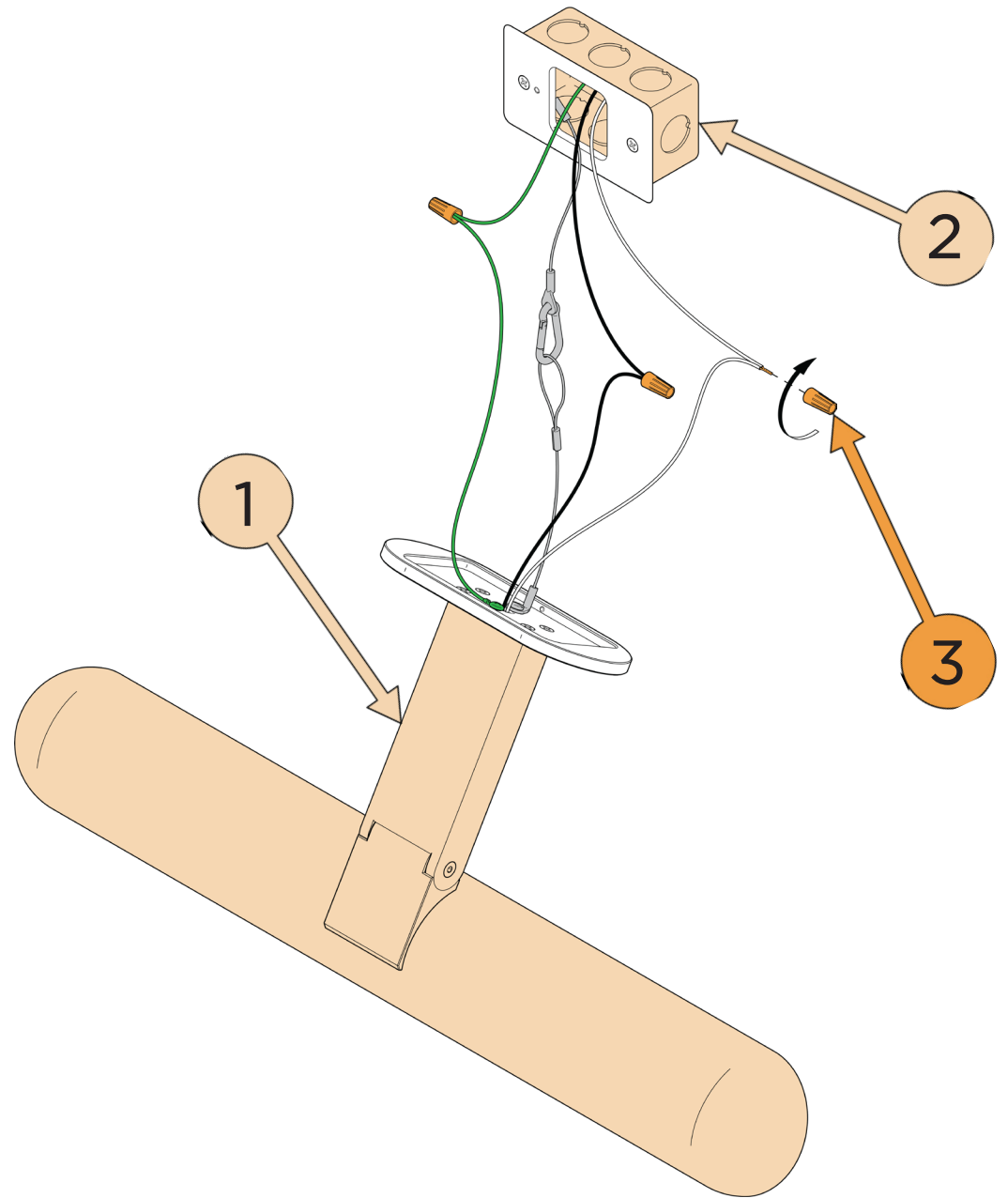

# 5

Tilt the **lighting fixture** ①  
to an upward angle.

Place the **canopy** ②  
over the **backplate** ③  
and let the **lighting fixture** ①  
rest into place.

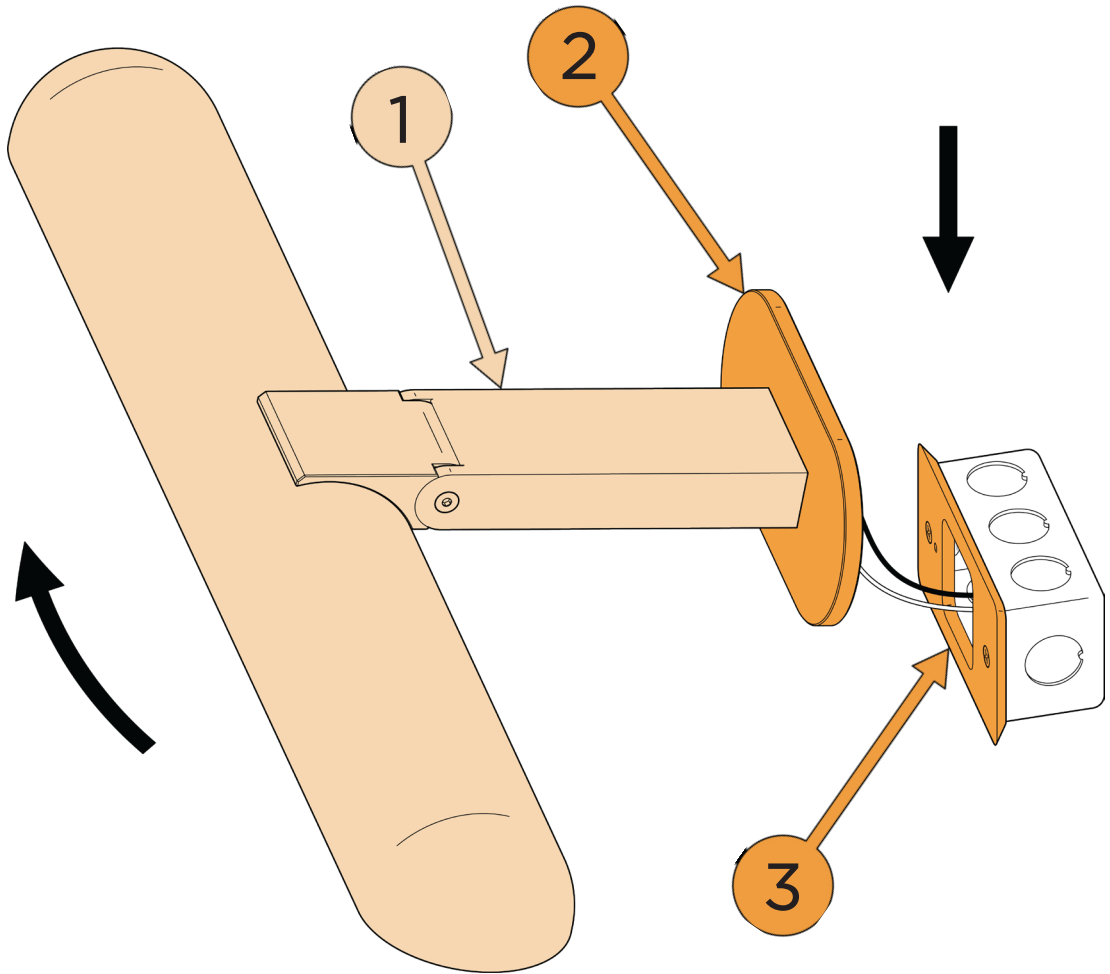



# 6

Using the hex driver ① tighten the set screw ② in the canopy ③ to secure the canopy ③ into place.

